

CONSTRUCTION PLANS FOR: CITY OF AUBURNDALE CENTER STREETSCAPE

CENTER STREET, AUBURNDALE, FLORIDA
SECTION 11, TOWNSHIP 28 SOUTH, RANGE 25 EAST

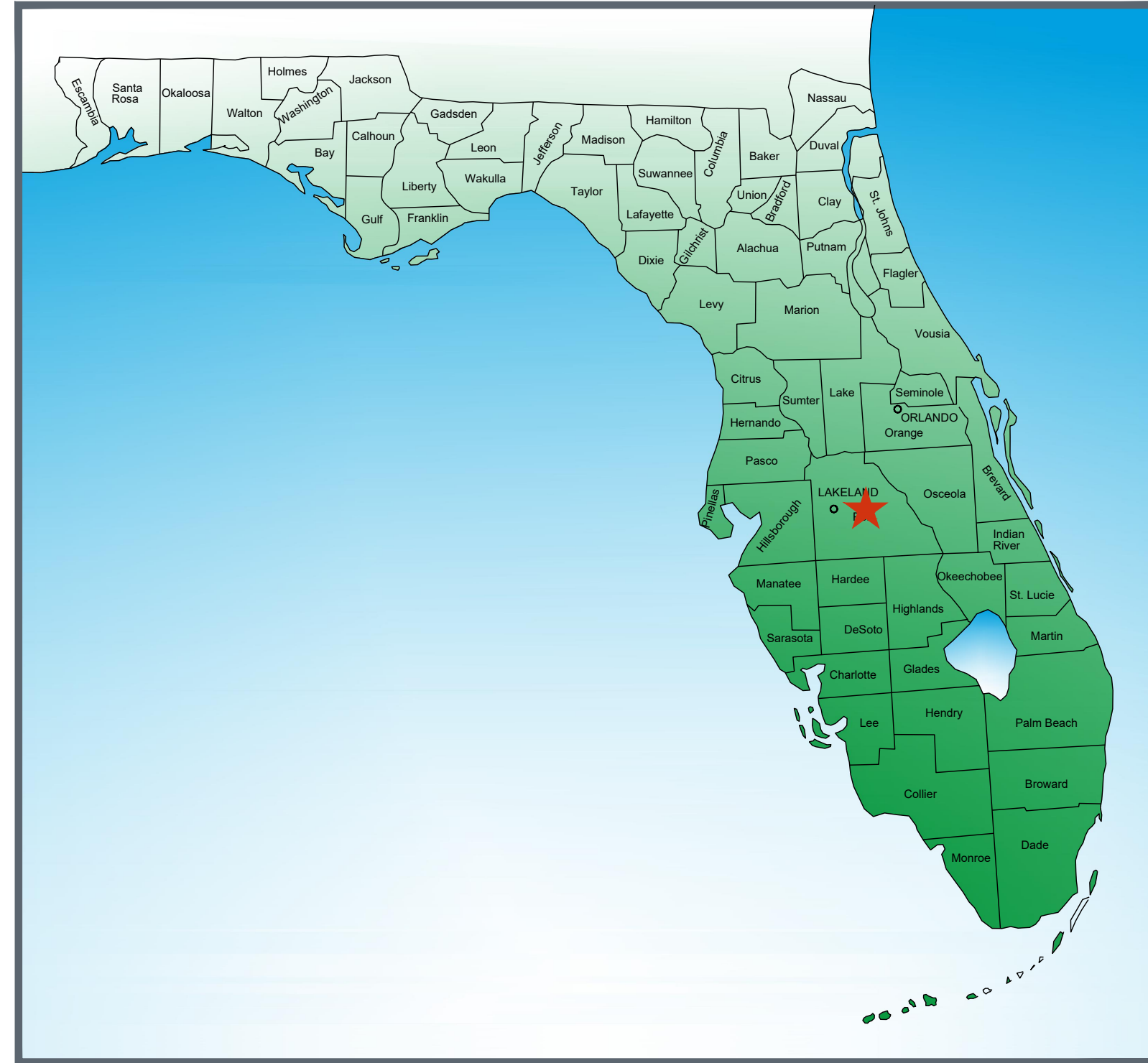

INDEX

- C-01 DEMOLITION PLAN
- C-02 SITE PLAN
- C-03-04 GENERAL CONSTRUCTION DETAILS & NOTES
- C-05-06 ROADWAY CROSS SECTIONS
- L-01 LANDSCAPE PLAN

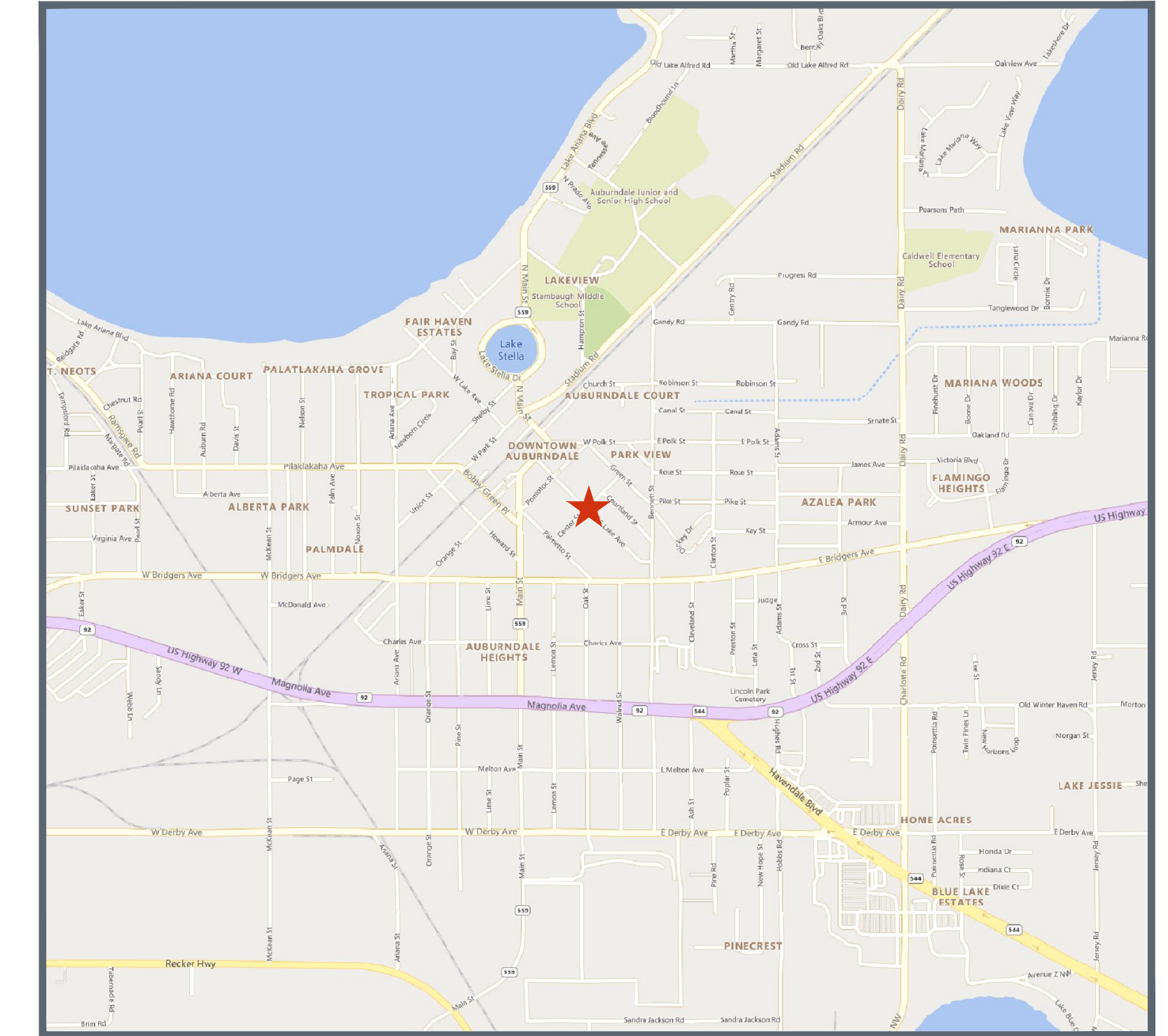

UTILITY PROVIDERS:

ELECTRIC:
TAMPA ELECTRIC COMPANY
LORENZO JONES
702 N FRANKLIN STREET
TAMPA, FL 33601
(813) 275.3427

WATER:
CITY OF AUBURNDALE
MANNY SILVA
915 CHARLES AVE.
AUBURNDALE, FL 33823
(863) 956.7743

SEWER:
CITY OF AUBURNDALE
MANNY SILVA
915 CHARLES AVE.
AUBURNDALE, FL 33823
(863) 956.7743

CABLE/FIBER:
FRONTIER COMMUNICATIONS
TONI CANNON
120 E LIME STREET
LAKELAND, FL 33801
(813) 875.1014

PHONE:
LUMEN (FKA CENTURYLINK)
TECH ON DUTY
555 LAKE BORDER DRIVE
APOPKA, FL 32703
(877) 366.8344 x3

GAS:
FLORIDA PUBLIC UTILITIES
GARY HARDY
1705 7TH ST SW
WINTER HAVEN, FL 33880
(863) 224.3786

ENGINEER OF RECORD:
CHARLES D. FORNI, P.E.
CHASTAIN SKILLMAN, INC.
205 EAST ORANGE STREET, SUITE #110
LAKELAND, FLORIDA 33801-4611
(863) 646.1402

DEVELOPER:
CITY OF AUBURNDALE
CONTACT NAME
1 BOBBY GREEN PLAZA
AUBURNDALE, FL 33823
(863) 965.5530

ARCHITECT/LANDSCAPE:
CATALYST DESIGN GROUP
CONTACT NAME
1085 W MORSE BLVD
WINTER PARK, FL 32789
(689) 219.8900



CHASTAIN-SKILLMAN (863) 646-1402 REG. NO 262
205 EAST ORANGE STREET, SUITE #110, LAKELAND, FLORIDA 33801-4611

SunShine811
Call 811 or www.sunshine811.com two full business days before digging to have utilities located and marked.
Check positive response codes before you dig!

NUMBER	DATE	DESCRIPTION
P-0	1/2022	ISSUED FOR REVIEW

This item has been digitally signed and sealed by SELECT ENGINEER on the date adjacent to seal. Printed copies of this document are not considered signed and sealed and the signature must be verified on any electronic copies.

ENGINEER: CHARLES D. FORNI, P.E.
REG. NO.: 866996
C.S.I. JOB NO. 10370.01

LEGEND:

- ROADWAY AREA TO BE REMOVED (PAVEMENT, CURB, WALK)
- POLE TO BE REMOVED
- EXISTING ROADWAY
- EXISTING SIDEWALK
- OVERHEAD POWER LINES TO BE REMOVED

- DEMOLITION NOTES:**
- A. OBTAIN PERMITS FROM LOCAL AUTHORITY.
 - B. PERFORM DEMOLITION IN ACCORDANCE WITH APPLICABLE AUTHORITIES HAVING JURISDICTION.
 - C. PROVIDE, ERECT AND MAINTAIN BARRICADES, LIGHTING, AND GUARD RAILS AS REQUIRED TO PROTECT GENERAL PUBLIC, WORKERS, AND ADJOINING PROPERTY.
 - D. COMPLETELY DEMOLISH STRUCTURES AND APPURTENANCES IN AN ORDERLY AND CAREFUL MANNER. REMOVE MATERIALS FROM SITE.
 - E. CEASE OPERATIONS AND NOTIFY ENGINEER IMMEDIATELY IF SAFETY OF ADJACENT STRUCTURES APPEARS TO BE ENDANGERED. TAKE PRECAUTIONS TO PROPERLY SUPPORT STRUCTURES. DO NOT RESUME OPERATIONS UNTIL SAFETY IS RESTORED.
 - F. REPAIR DEMOLITION PERFORMED IN EXCESS OF THAT REQUIRED AT NO COST TO THE OWNER.
 - G. REMOVE FROM SITE, CONTAMINATED, VERMIN INFESTED, OR DANGEROUS MATERIALS ENCOUNTERED AND DISPOSE OF BY SAFE MEANS SO AS NOT TO ENDANGER HEALTH OF WORKERS AND PUBLIC.
 - H. BACKFILL ALL AREAS EXCAVATED AS A RESULT OF DEMOLITION. REMOVE DEMOLISHED MATERIALS, TOOLS AND EQUIPMENT OF WORK. LEAVE SITE IN CONDITION ACCEPTABLE TO OWNER / ENGINEER.
 - I. PLACE MARKERS TO INDICATE LOCATION OF DISCONNECTED SERVICES. IDENTIFY SERVICE LINES AND CAPPING LOCATIONS ON PROJECT RECORD DOCUMENTS. COORDINATE WITH CITY OF AUBURNDALE.
 - J. CONTRACTOR IS RESPONSIBLE TO REPAIR ANY ACTIVE UNDERGROUND UTILITY OR INFRASTRUCTURE IMPROVEMENT DAMAGE DURING DEMOLITION OR CONSTRUCTION OF PROPOSED IMPROVEMENTS. ENGINEER AND CITY WILL DETERMINE IF A DAMAGED UTILITY OR INFRASTRUCTURE IMPROVEMENT IS ACTIVE.
 - K. EXISTING WATER LINES SHALL STAY IN SERVICE.
 - L. THE CONTRACTOR SHALL ENSURE THAT SEDIMENT AND DEBRIS ARE NOT INTRODUCED INTO THE CITY SEWER SYSTEM.
 - M. EXISTING FENCES SHALL BE MAINTAINED EXCEPT WHERE NOTED. CONTRACTOR IS RESPONSIBLE TO REPLACE AND DAMAGED FENCES AS A RESULT OF CONSTRUCTION ACTIVITIES. CONTRACTOR TO GET WRITTEN APPROVAL FROM PROPERTY OWNERS SHOULD FENCING NEED TO BE REMOVED TEMPORARILY.
 - N. ACCESS TO RESIDENCES AND BUSINESSES TO REMAIN OPEN DURING CONSTRUCTION. TEMPORARY STABILIZED DRIVES AND ACCESS TO BE PROVIDED BY CONTRACTOR.
 - O. SAW OUT ALL CONCRETE TO NEAREST CONTROL/EXPANSION WHEN REMOVING CONCRETE.
 - P. CONTRACTOR IS TO CONFIRM LIMITS OF DEMOLITION AT BUILDING FACES WITH ENGINEER PRIOR TO REMOVAL.
 - Q. CONTRACTOR IS TO REMOVE CERTAIN AMENITIES I.E. LIGHTS, NEWSPAPER STANDS BENCHES ETC. AND PROVIDE THEM TO THE CITY UNDAMAGED AS DIRECTED TO CITY STORAGE FACILITIES.

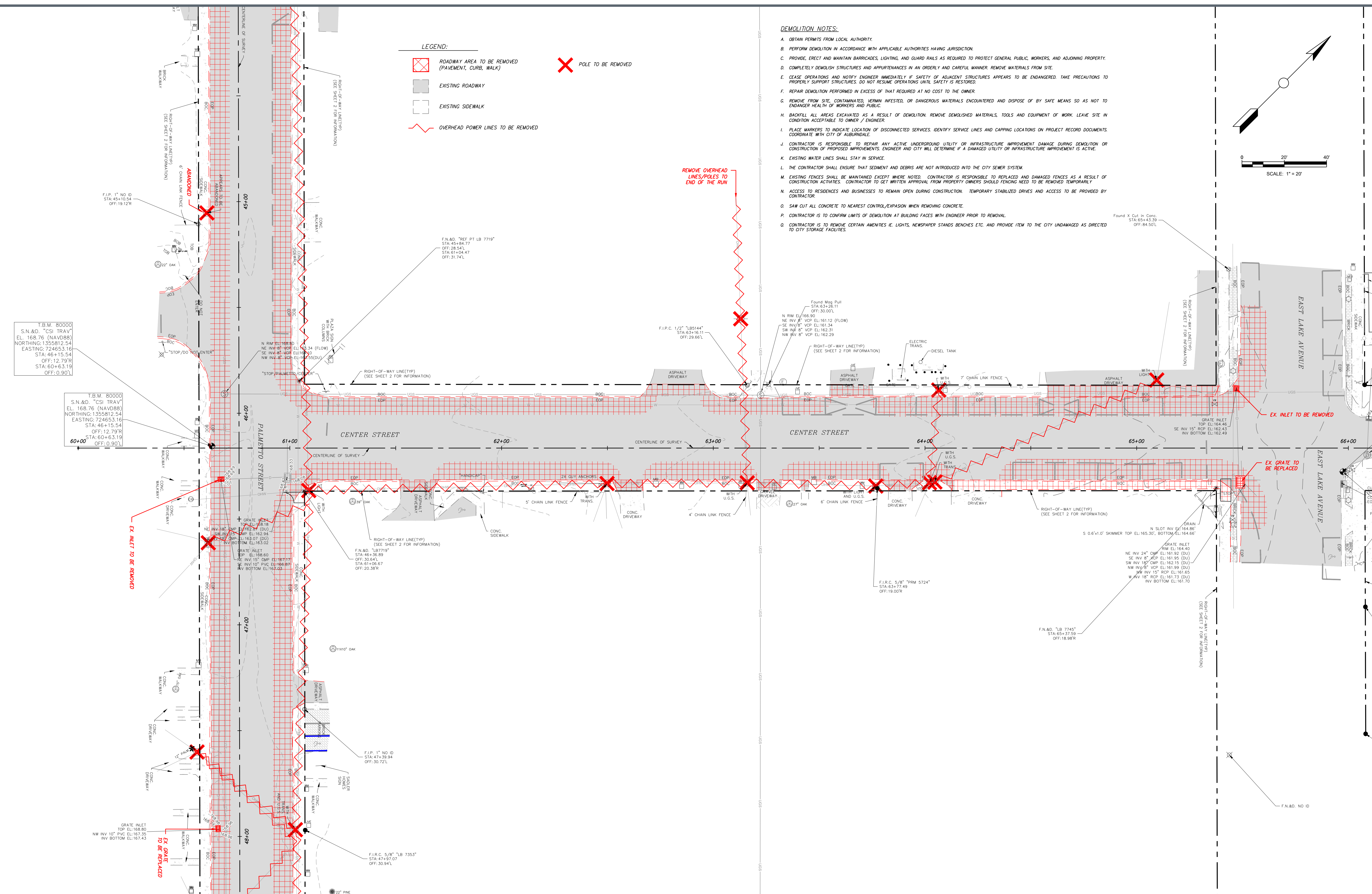
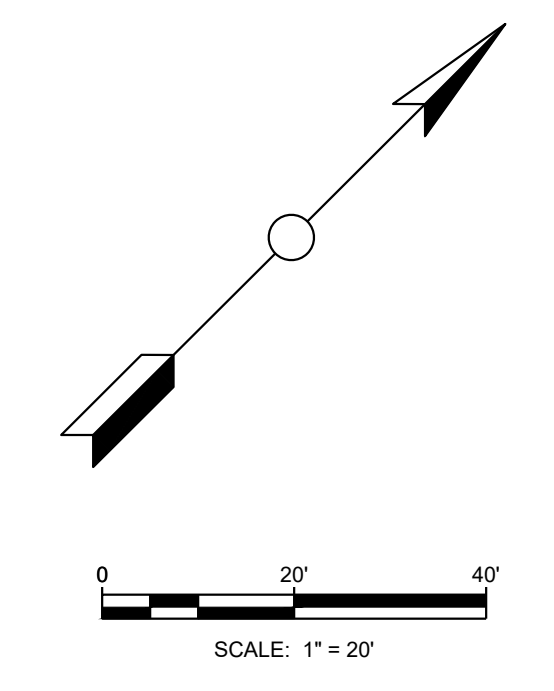

P:\1037001\CAD\Gis\1037001\Production\Drawings\1037001-CDF-2023-DEM0.dwg CENTER STREET Mar 25, 2024 11:08am by: androguz

NUMBER	DATE	DESCRIPTION
P-0	3/2023	ISSUED FOR REVIEW

CHASTAIN-SKILLMAN
 205 EAST ORANGE STREET
 SUITE #110
 LAKELAND, FL 33801-4611
 (863) 646-1402



CITY OF AUDURDALE
 CENTER STREETScape
 CENTER STREET, AUBURNDALE, FLORIDA

DEMOLITION

This item has been digitally signed and sealed by Charles D. Forni on the date adjacent to seal. Printed copies of this document are not considered signed and sealed and the signature must be verified on any electronic copies.

PROJECT NUMBER:
1037001

SHEET NUMBER:
C-01

March 25, 2024 ENGINEER: CHARLES D. FORNI, P.E.
 REG. NO.: 86698

- LEGEND:**
- EXISTING CONCRETE SIDEWALK
 - PROPOSED CONCRETE SIDEWALK
 - PROPOSED 6" CONCRETE DRIVE ENTRANCE
 - PROPOSED ASPHALT DRIVE ENTRANCE
 - BRICK PAVERS
 - PROPOSED CURB AND GUTTER
 - EXISTING ROADWAY
 - PROPOSED STREET LIGHTING

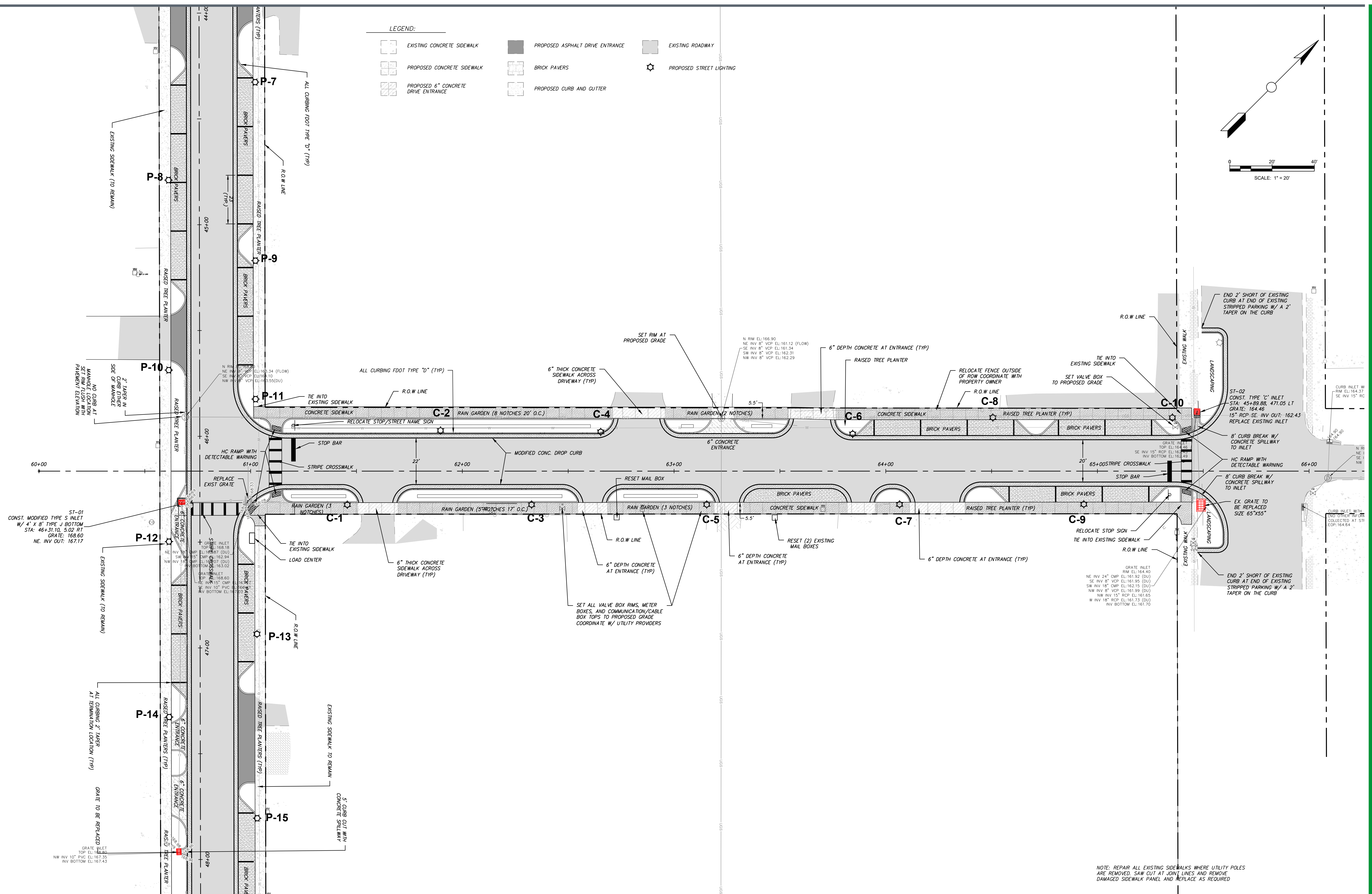
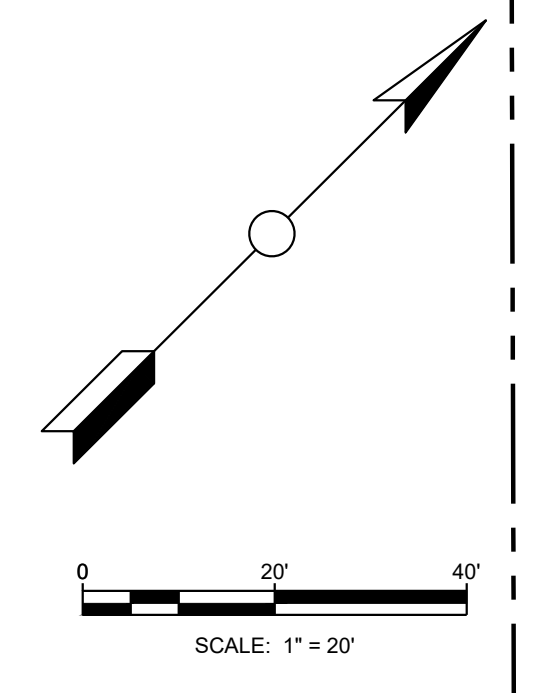

NOTE: REPAIR ALL EXISTING SIDEWALKS WHERE UTILITY POLES ARE REMOVED. SAW CUT AT JOINT LINES AND REMOVE DAMAGED SIDEWALK PANEL AND REPLACE AS REQUIRED.

P:\1037001\CAD\GIS\1037001\Production Drawings\1037001-CDF-2023-SITE.dwg - CENTER STREET - Mar 25, 2024, 11:18am, by: mrodriguez

NUMBER	DATE	DESCRIPTION
P-0	1/2023	ISSUED FOR REVIEW

CHASTAIN-SKILLMAN
 205 EAST ORANGE STREET
 SUITE #110
 LAKELAND, FL 33801-4611
 (863) 646-1402



© 2023 CHASTAIN SKILLMAN REG. NO. 282

CITY OF AUDURDALE
 CENTER STREETScape
 CENTER STREET, AUBURNDALE, FLORIDA

SITE PLAN

This item has been digitally signed and sealed by Charles D. Forni on the date adjacent to seal. Printed copies of this document are not considered signed and sealed and the signature must be verified on any electronic copies.

March 25, 2024 ENGINEER: CHARLES D. FORNI, P.E.
 REG. NO.: 86698

PROJECT NUMBER:
 1037001

SHEET NUMBER:
 C-02

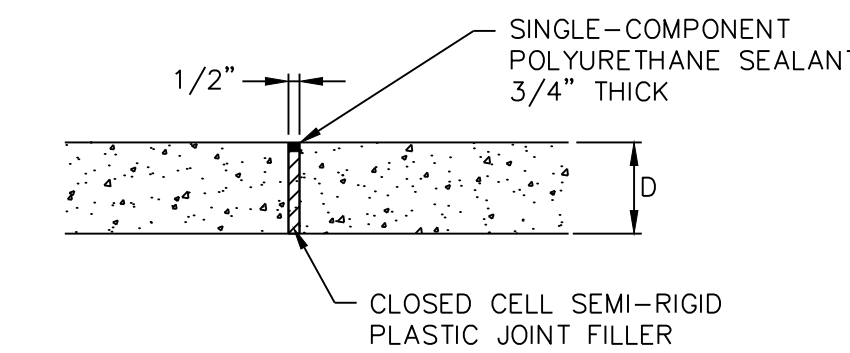

1/2" EXPANSION JOINT

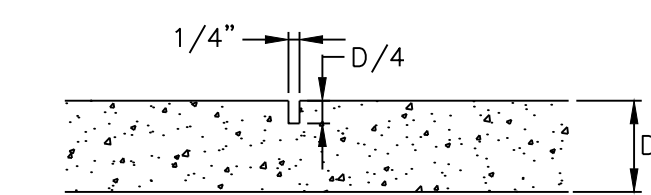

CONTROL JOINT

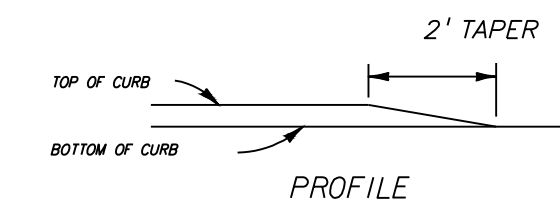

TAPERED END CURB "D"
N.T.S.

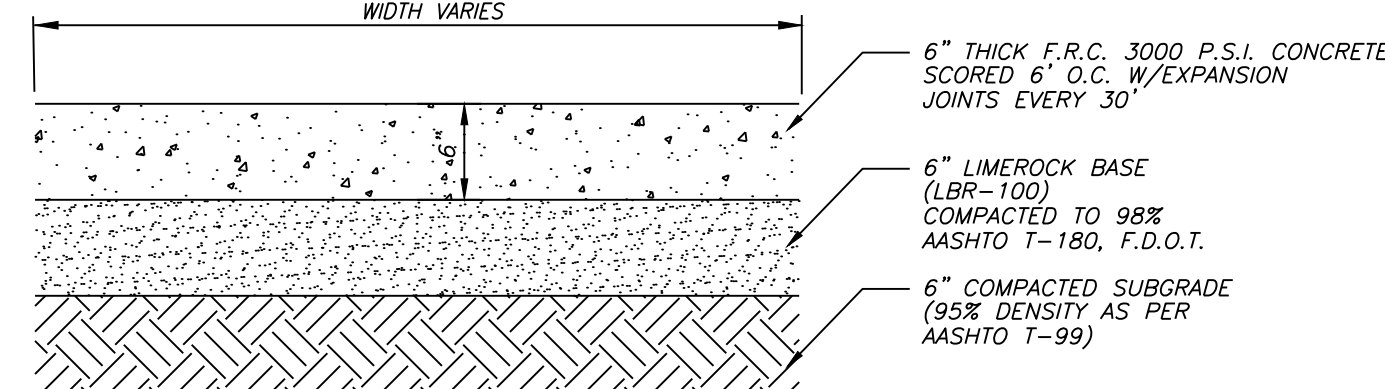

DRIVEWAY ENTRANCES
N.T.S.

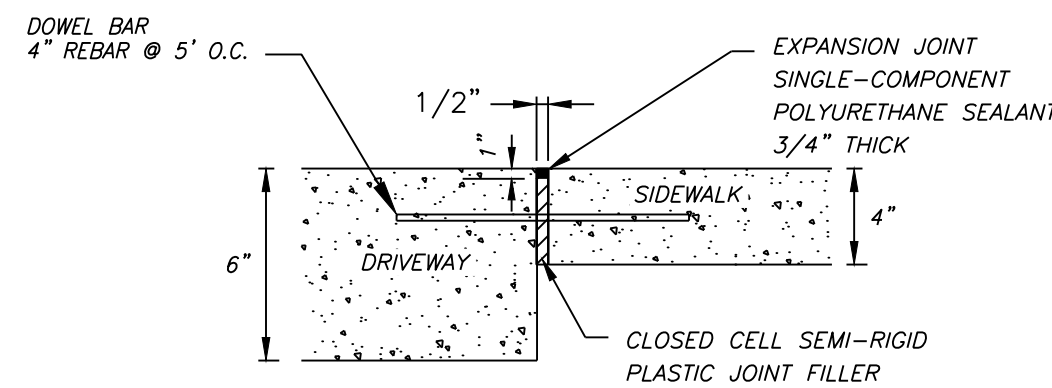

SIDEWALK AND DRIVEWAY CONNECTION DETAIL
N.T.S.

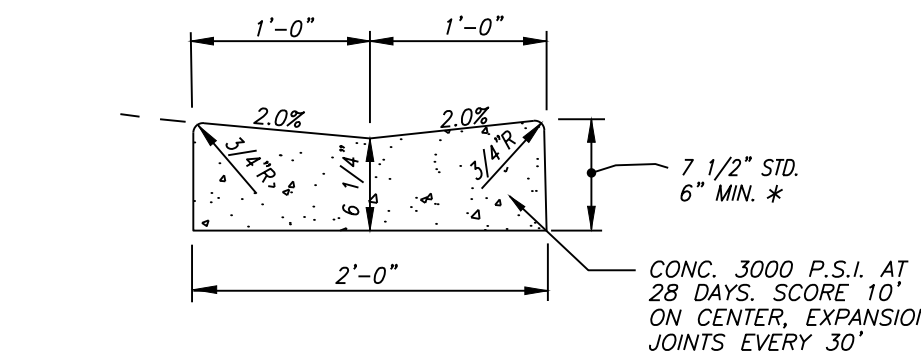

MODIFIED DROP CURB (VALLEY GUTTER)
N.T.S.

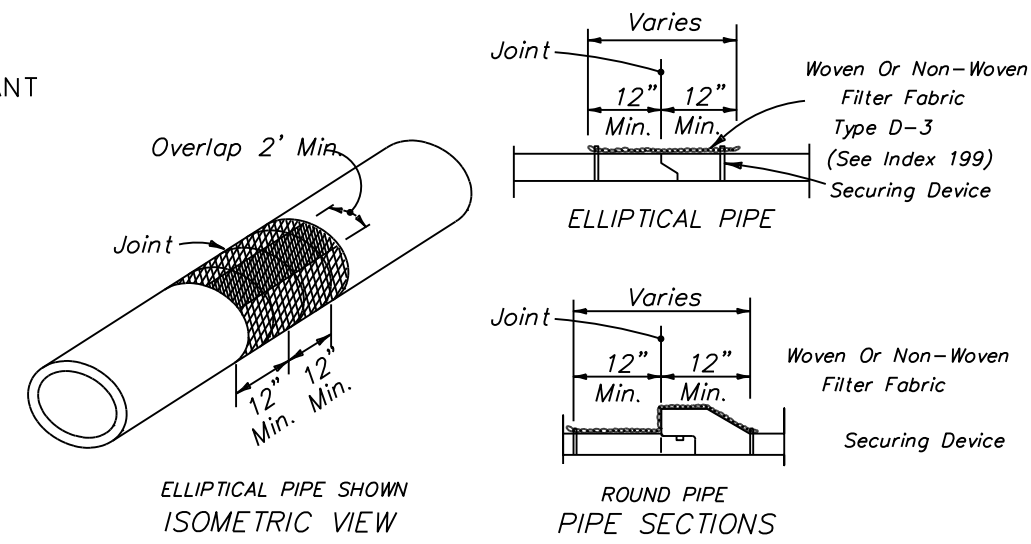

FILTER FABRIC JACKET
SEE D.O.T. INDEX 280
N.T.S.

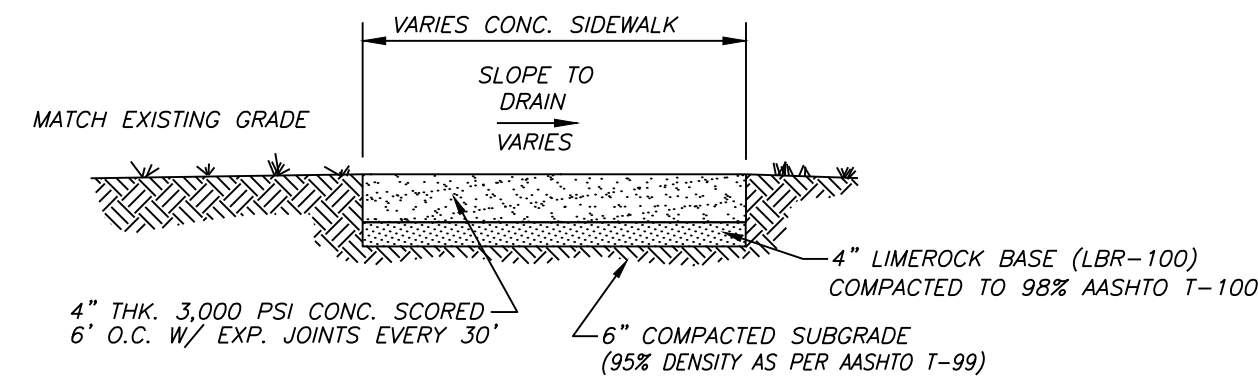

SIDEWALK DETAIL
N.T.S.

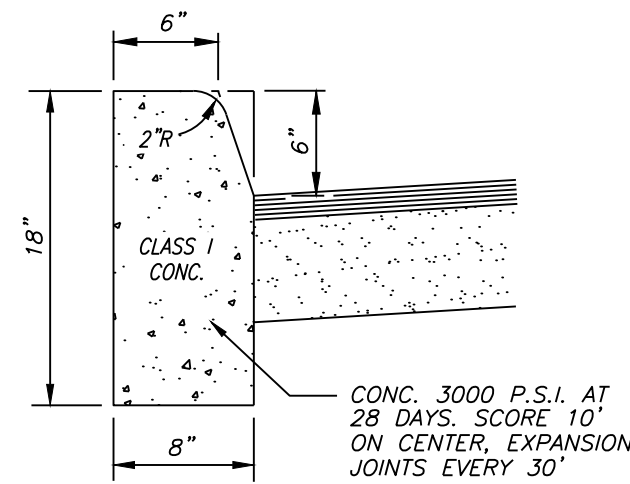

TYPE "D" CURB
N.T.S.

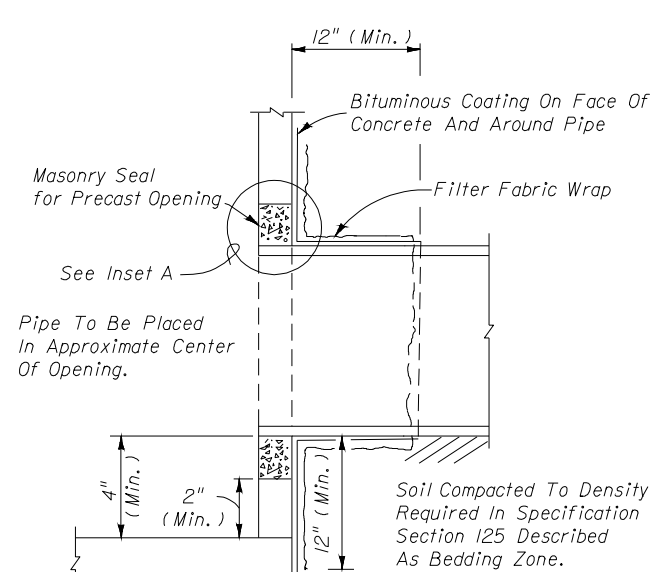

FILTER FABRIC WRAP ON GROUTED PIPE TO STRUCTURE JOINT
SEE F.D.O.T. INDEX 425-001
N.T.S.

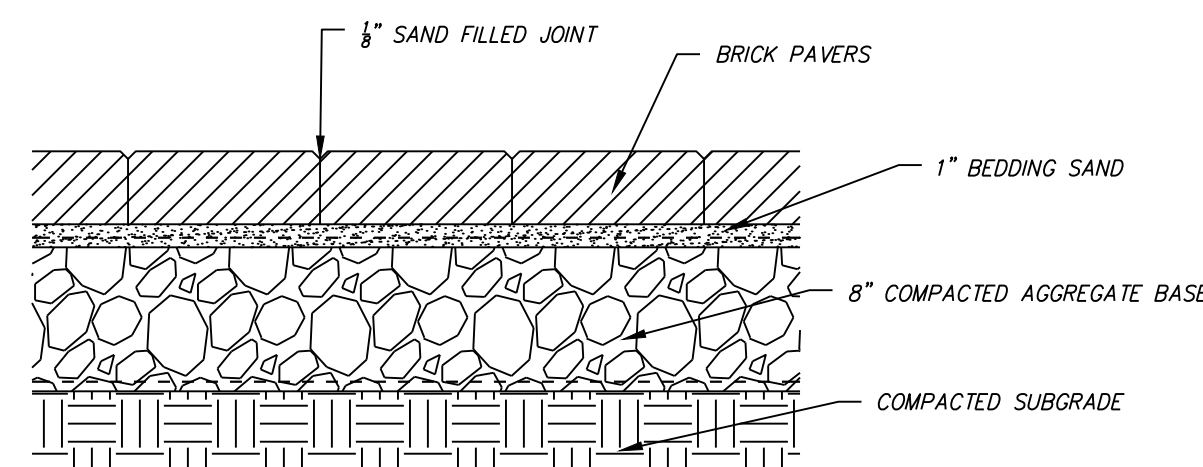

PAVER
N.T.S.

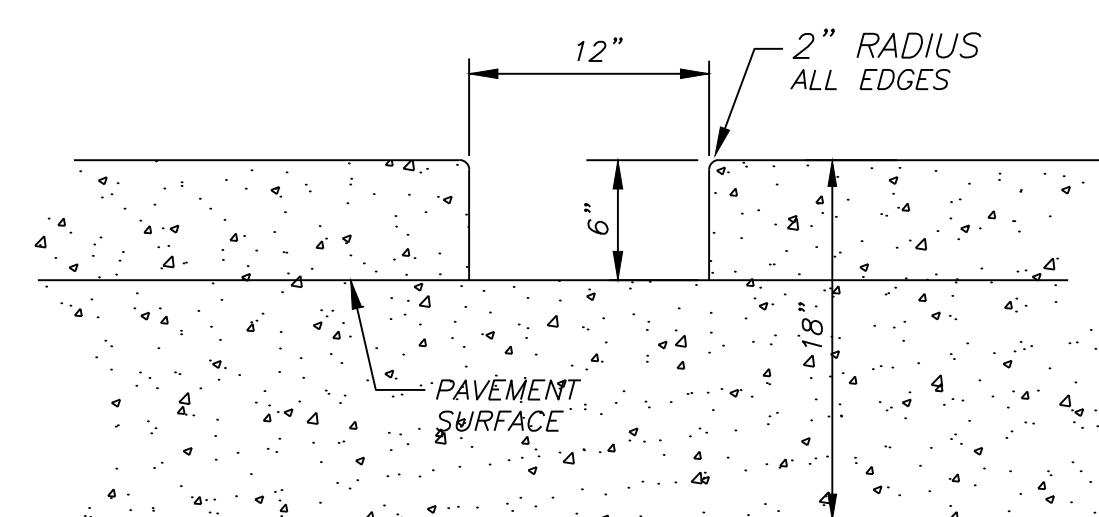

RAIN GARDEN CURB CUT NOTCHES
N.T.S.

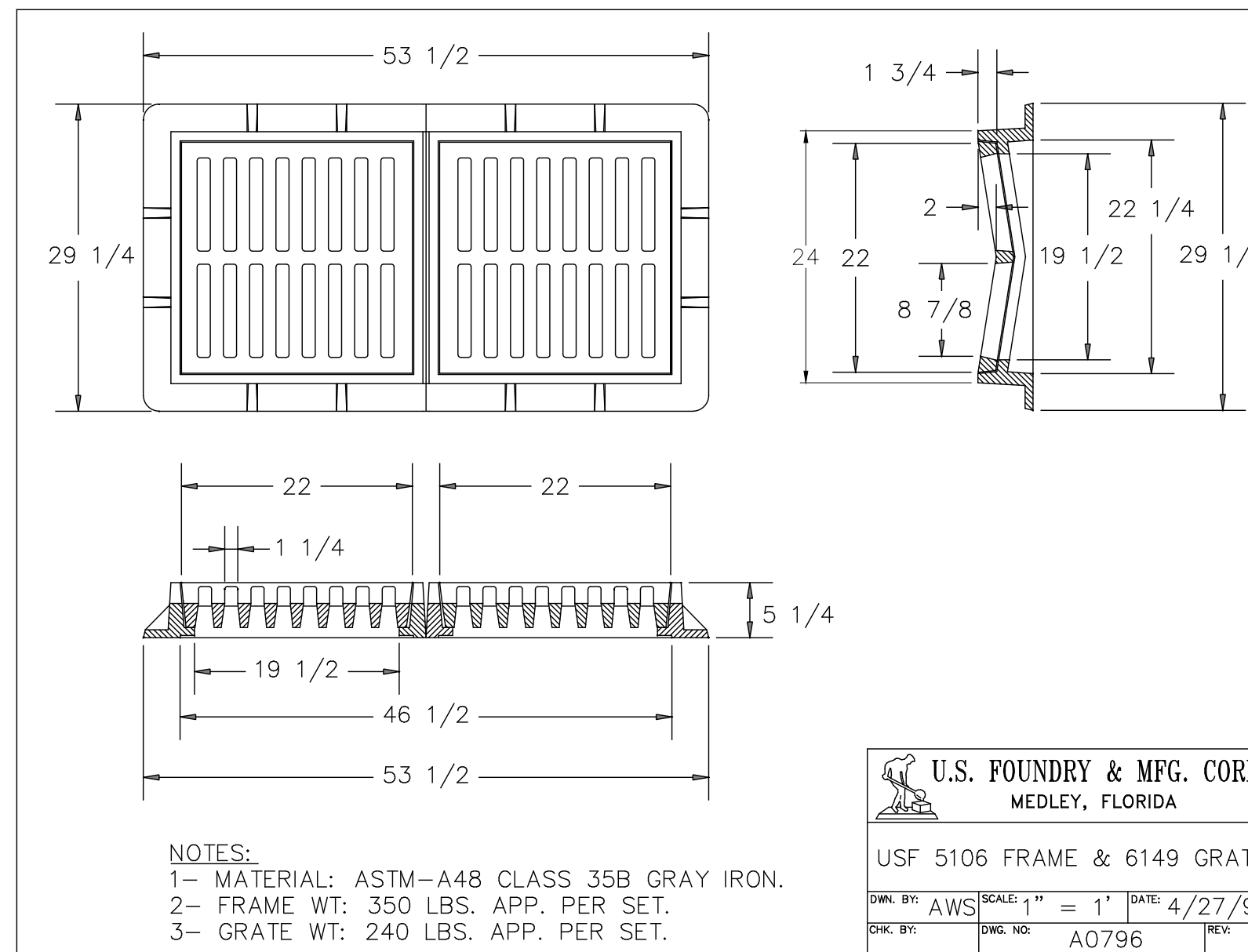

NOTES:
1- MATERIAL: ASTM-A48 CLASS 35B GRAY IRON.
2- FRAME WT: 350 LBS. APP. PER SET.
3- GRATE WT: 240 LBS. APP. PER SET.

U.S. FOUNDRY & MFG. CORP.
MEDLEY, FLORIDA
USF 5106 FRAME & 6149 GRATE
DWN. BY: AWS SCALE: 1" = 1" DATE: 4/27/95
CHK. BY: DWG. NO. A0796

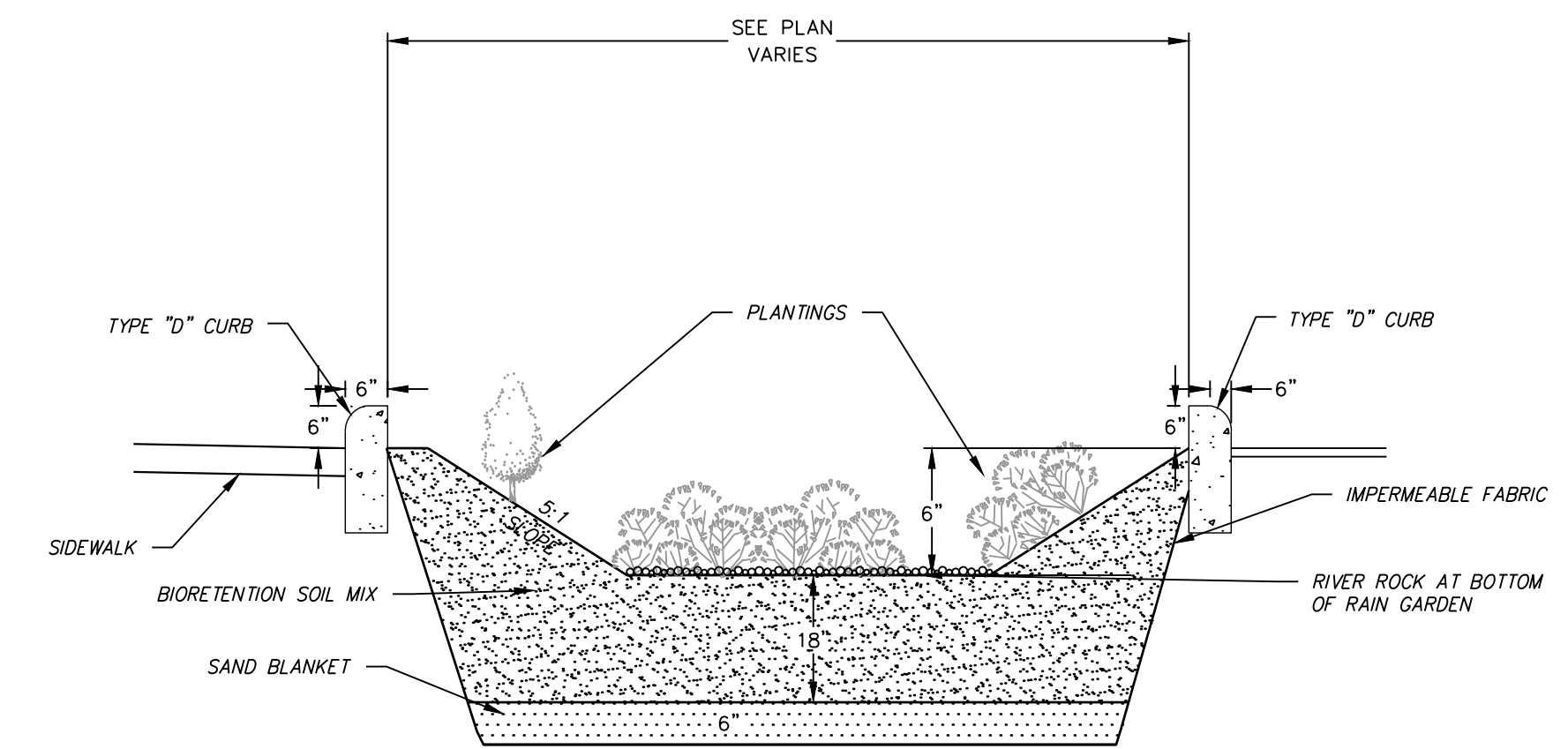

RAIN GARDEN DETAIL
N.T.S.

NOTE: CONTRACTOR TO PERFORM PERC TEST IN RAIN GARDENS PRIOR TO INSTALLATION TO DETERMINE INFILTRATION RATES. PROVIDE RESULTS TO ENGINEER.

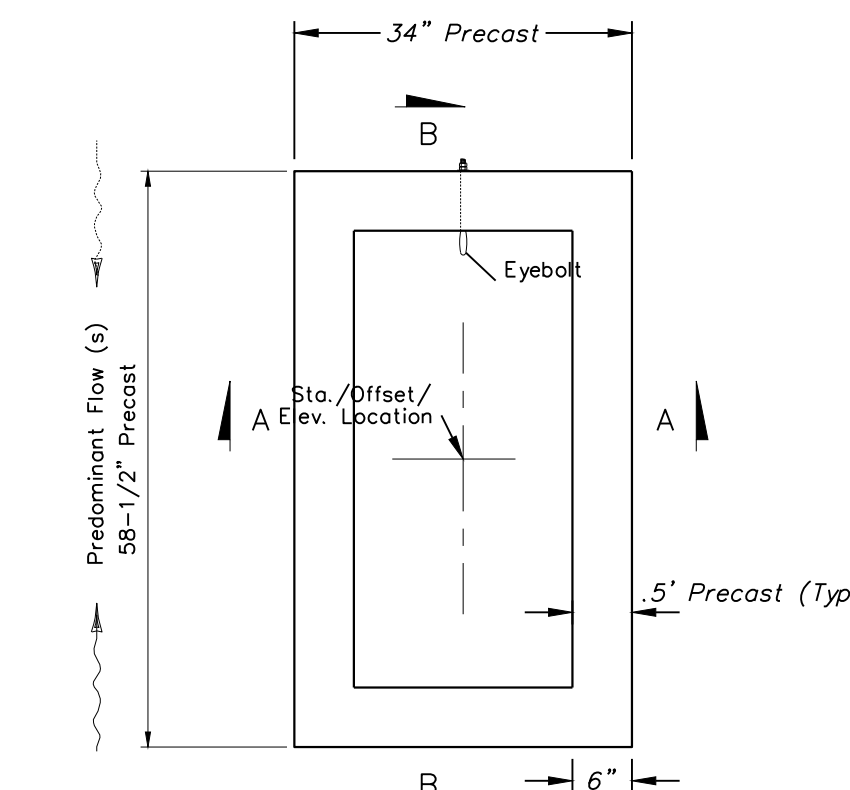

WALL DEPTH	SCHEDULE	AREA (in ² /ft)	MAX. SPACING
		BARS	WWR
0' - 5'	A12	0.20	12" 8"
5' - 9'	A6	0.20	6" 5"
9' - 12'	A4	0.24	4" 3"
9' - 15'	B5.5	0.24	5 1/2" 5"

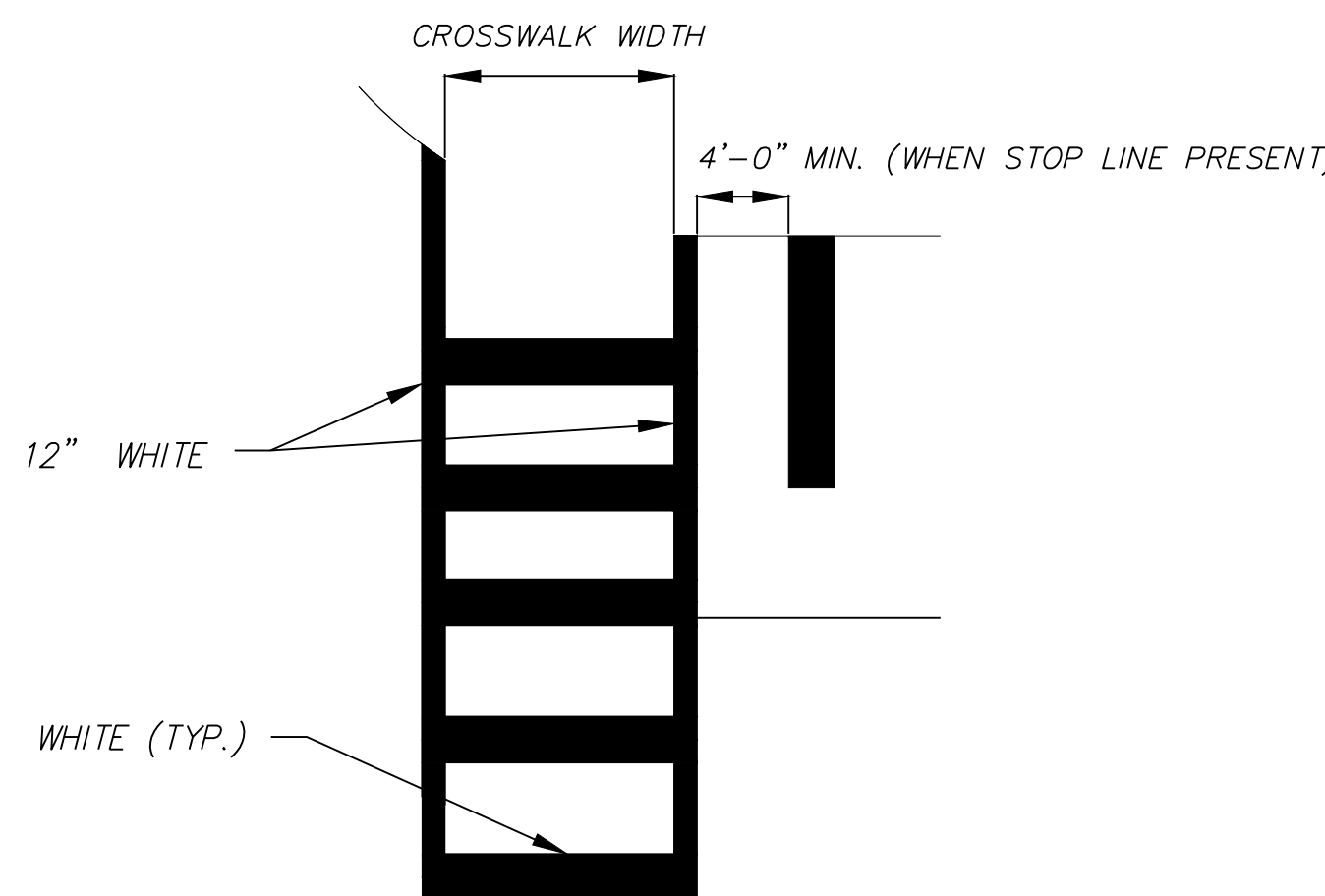

SPECIAL EMPHASIS CROSSWALK DETAILS

NOTES:
1. FOR CROSSWALK WIDTH, EXCEED WIDTH OF THE ADJACENT SIDEWALK, BUT DO NOT MAKE WIDTH LESS THAN 6' FOR INTERSECTION CROSSWALK AND 10' FOR MIDBLOCK CROSSWALKS. MEASURE WIDTH FROM THE INSIDE OF THE TRANSVERSE CROSSWALK MARKINGS.
2. WHEN THE SPECIAL EMPHASIS CROSSWALK IS NOT PERPENDICULAR TO THE LANE LINES, MAKE THE LONGITUDINAL MARKINGS PARALLEL TO THE LANE LINES.
3. REFER TO INDEX 522-002 WHEN CURB RAMPS ARE PRESENT.

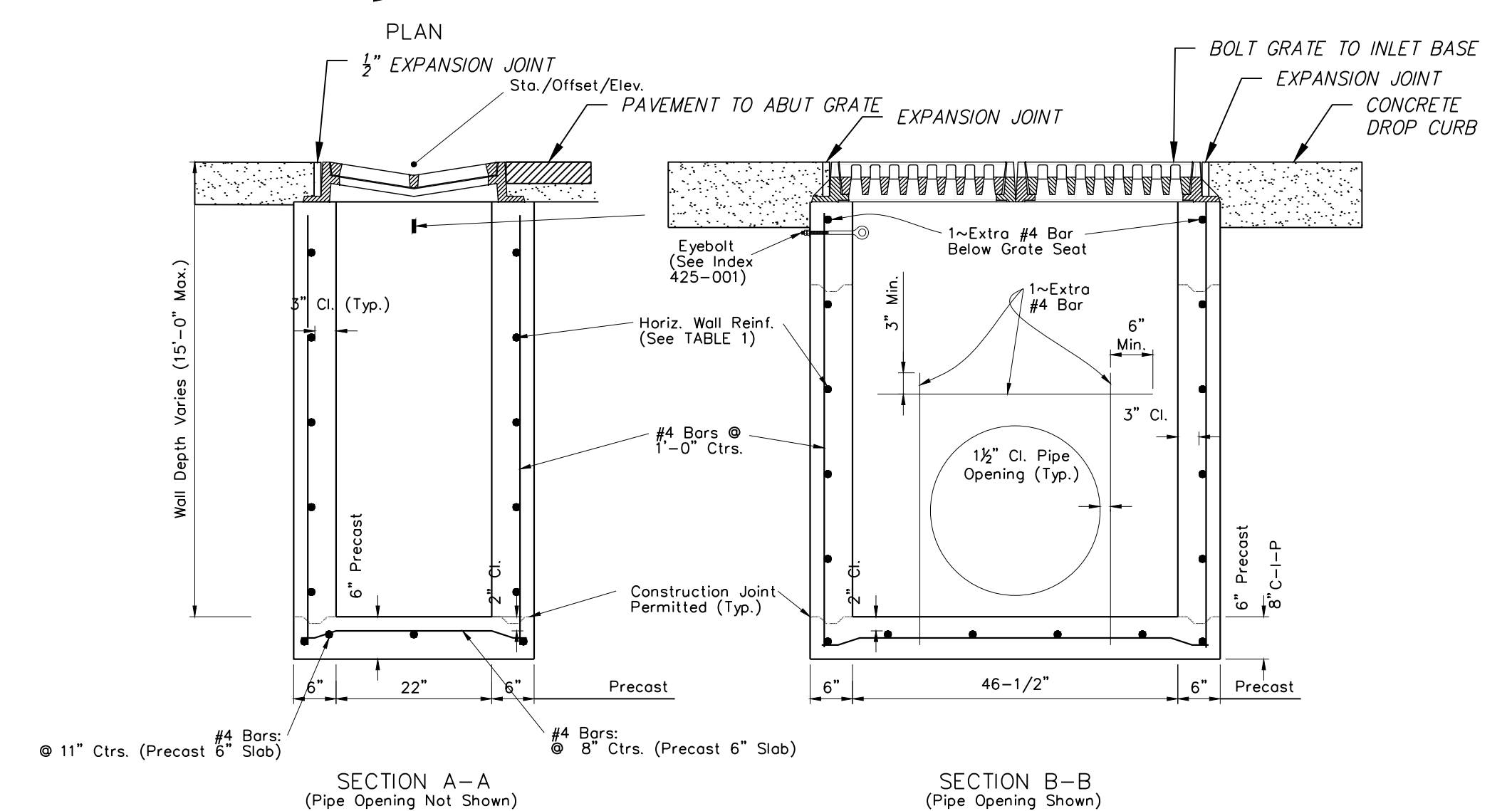

MODIFIED GUTTER INLET TYPE S

NUMBER	DATE	DESCRIPTION
P-0	1/2023	ISSUED FOR REVIEW

CHASTAIN-SKILLMAN
205 EAST ORANGE STREET
SUITE #110
LAKELAND, FL 33801-4611
(863) 646-1402



© 2023 CHASTAIN SKILLMAN REG. NO. 282

CITY OF AUDURDALE
CENTER STREETSCAPE
CENTER STREET, AUBURDALE, FLORIDA
GENERAL CONSTRUCTION DETAILS & NOTES

This item has been digitally signed and sealed by Charles D. Forni on the date adjacent to seal. Printed copies of this document are not considered signed and sealed and the signature must be verified on any electronic copies.

PROJECT NUMBER:
1037001

SHEET NUMBER:
C-03

March 25, 2024 ENGINEER: CHARLES D. FORNI, P.E.
REG. NO.: 86698

MAINTENANCE OF TRAFFIC NOTES:

MAINTENANCE OF TRAFFIC FOR WORK WITHIN THE RIGHT-OF-WAY SHALL BE IN ACCORDANCE WITH THE LATEST EDITION OF THE MANUAL ON UNIFORM TRAFFIC CONTROL DEVICES (MUTCD) AND THE FLORIDA DEPARTMENT OF TRANSPORTATION (FDOT) DESIGN STANDARDS. THE MOT PLAN MUST COMPLY WITH FDOT STANDARD DRAWING #600. THE SPECIFIC MOT PLANS TO BE USED FOR WORK WITHIN THE R/W OF SR 17 (POSTED SPEED 30 MPH) INCLUDE INDEX 611, 612, 613, 614, 615, 617, 622 AND 660 DEPENDING UPON THE LOCATION, DURATION, AND EXTENT OF THE WORK.

NOTE:

THE CONTRACTOR IS RESPONSIBLE FOR IDENTIFYING THE WORK ZONE TRAFFIC CONTROL SUPERVISOR PRIOR TO THE START OF ANY WORK WITHIN THE RIGHT-OF-WAY. PROVIDE A COPY OF THE WORKSITE TRAFFIC SUPERVISOR'S (WTS) CERTIFICATE OF QUALIFICATION FOR HAVING COMPLETED AN FDOT APPROVED COURSE IN ADVANCED MAINTENANCE OF TRAFFIC.

GENERAL

THE CONTRACTOR IS REQUIRED TO PROVIDE "RECORD DRAWING" INFORMATION TO THE ENGINEER. THE TYPE OF INFORMATION IS DETAILED BELOW. FOR HORIZONTAL LOCATIONS, THE INTENT IS TO LOCATE ALL UTILITY FEATURES WITH AT LEAST TWO MEASUREMENTS FROM DIFFERENT ANGLES AND REFERENCE POINTS. IT IS PREFERABLE FOR ALL DISTANCES TO BE LESS THAN 100 FEET. IT IS IMPORTANT THAT THE RECORD DRAWING INFORMATION BE PROVIDED ON A TIMELY BASIS. OFTEN, AS MANY AS THREE SEPARATE RECORD DRAWING SUBMITTALS TO THE ENGINEER ARE REQUIRED, ONE FOR WATER, ONE FOR WASTEWATER, AND ONE FOR STORM WATER. THE TIMING IS DETERMINED BY THE OWNER. FURTHER, INTERIM RELEASES OF UTILITIES ARE OFTEN NECESSARY, EACH REQUIRING A SEPARATE RECORD DRAWING SUBMITTAL TO THE ENGINEER. IT IS THE CONTRACTOR'S RESPONSIBILITY TO COORDINATE AND PROVIDE THE INFORMATION TO THE ENGINEER ON A TIMELY BASIS EVEN IF CHASTAIN-SKILLMAN IS EMPLOYED TO SURVEY THE DATA. THE ENGINEER RESERVES THE RIGHT TO REQUEST INFORMATION NOT INCLUDED HEREIN WITHOUT RESPONSIBILITY FOR COST.

CERTIFICATION & SUBMITTAL: FOR SURVEYOR PORTION:

SIX SETS OF THE PLANS SHALL BE SUBMITTED WITH EACH PAGE DATED, SIGNED, AND SEALED BY THE LICENSED SURVEYOR UNDER THE STATEMENT "I HEREBY CERTIFY THE RECORD DRAWING ELEVATIONS AND LOCATIONS SHOWN AND ADDED TO THESE PLANS WERE OBSERVED AND MEASURED BY ME FOR A SPECIFIC PURPOSE TO PROVIDE RECORD DRAWING INFORMATION, IDENTIFIED BY "(RD)". IN ADDITION, AN ELECTRONIC FILE IN AUTOCAD FORMAT OF THE RECORD DRAWING DRAWINGS SHALL BE SUBMITTED. THE SURVEY INFORMATION SHALL BE DRAFTED ONTO THE LATEST DRAWING OBTAINED FROM CHASTAIN-SKILLMAN ENGINEER. ALL DRAWING SCALES, TEXT SIZES, LINE WIDTHS, LINE STYLES, SHEET LAYOUTS AND PRESENTATION METHODS INCLUDED IN THE ORIGINAL FILE MUST BE MAINTAINED. IF PROFILE VIEWS ARE INCLUDED IN THE DRAWING SET, THEY MUST BE UPDATED WITH THE RECORD DRAWING INFORMATION.

FOR CONTRACTOR PORTION:

ONE SET OF THE PLANS SHALL BE SUBMITTED WITH EACH PAGE DATED AND SIGNED BY THE CONTRACTOR UNDER THE STATEMENT "I HEREBY CERTIFY THE RECORD DRAWING ELEVATIONS AND LOCATIONS SHOWN AND ADDED TO THESE PLANS WERE OBSERVED AND MEASURED BY ME FOR A SPECIFIC PURPOSE TO PROVIDE RECORD DRAWING INFORMATION, IDENTIFIED BY "(RD)". THE SURVEY INFORMATION SHALL BE HAND-ANNOTATED ONTO THE LATEST CONSTRUCTION DRAWING OBTAINED FROM THE CHASTAIN-SKILLMAN. IF PROFILE VIEWS ARE INCLUDED IN THE DRAWING SET, THEY MUST BE UPDATED WITH THE RECORD DRAWING INFORMATION.

CSI SURVEY SCHEDULING

ANY PROFESSIONAL LAND SURVEYOR AND MAPPER REGISTERED IN FLORIDA MAY DO THE WORK REQUIRED OF A REGISTERED SURVEYOR. HOWEVER, IF CHASTAIN-SKILLMAN IS CONTRACTED TO PROVIDE CONSTRUCTION STAKING/LAYOUT (WHERE SURVEY CONTROL POINTS AND ELEVATIONS ARE ALREADY SET AND FIELD PERSONNEL ARE FAMILIAR WITH THE PROJECT), THEN 2 BUSINESS DAYS NOTICE MUST BE GIVEN TO CHASTAIN-SKILLMAN FOR THE MEASUREMENT OF "RECORD DRAWING" DATA. IF CHASTAIN-SKILLMAN IS CONTRACTED TO PROVIDE ONLY THE RECORD DRAWING SURVEY, THEN CHASTAIN-SKILLMAN SHOULD BE GIVEN 5 BUSINESS DAYS NOTICE.

THE FOLLOWING SHALL TO BE PROVIDED BY A LAND SURVEYOR LICENSED IN THE STATE OF FLORIDA (PSM):

WATER:

- 1. ELEVATION OF THE WATER MAINS WHERE CROSSINGS WITH SEWER OR STORM WATER LINES OCCUR.
2. LOCATION OF ALL MAINLINE VALVES, BACKFLOW PREVENTERS, FITTINGS/ELBOWS AND AIR RELEASE VALVES.

WASTEWATER:

- 1. ALL ELEVATIONS OF SEWER INVERTS IN ALL MANHOLES, RIM ELEVATIONS OF MANHOLES, AND LOCATION OF MANHOLES SHALL BE PROVIDED.
2. PUMP STATION TOP OF SLAB, INFLUENT INVERT ELEVATION, BOTTOM INVERT OF WET WELL.
3. LOCATIONS OF ALL MAINLINE VALVES, AIR RELEASE VALVES, ELBOWS/FITTINGS, AND CHECK VALVES.

STORM WATER

- 1. CONTROL STRUCTURE ELEVATIONS (GRATE, WEIR, WIDTH, AND CREST ELEVATION, BOTTOM ELEVATION, VEE NOTCH DIMENSIONS, ORIFICE DIAMETER AND INVERT ELEVATION, OVERFLOW ELEVATION, BLEED-DOWN ORIFICE SHAPE, SIZE, AND INVERT ELEVATION, TOP, SKIMMER DIMENSIONS AND ELEVATION, UNDERDRAIN DIMENSIONS, ETC.).
2. ALL INVERT ELEVATIONS, THE RIM/TOP OF GRATE ELEVATIONS OF DRAINAGE STRUCTURES AND THE FLOW LINE OF EACH PIPE.
3. THE DIMENSIONS ACROSS THE POND AND BIOSWALE BOTTOMS (LENGTH AND WIDTH) SHALL BE PROVIDED.
4. THE INVERT ELEVATION OF STORM PIPES AT MITERED END SECTIONS SHALL BE PROVIDED.
5. PROVIDE TYPICAL SPOT ELEVATIONS WITHIN THE PROJECT SITE (I.E., PAVEMENT SHOTS, TOP OF CURB, ETC.).
6. FOR EACH STORM WATER RETENTION/DETENTION POND AND BIOSWALE, AT LEAST FOUR SPOT ELEVATION SHOTS AT THE BASE OF THE POND AND AT LEAST FOUR SPOT ELEVATION SHOTS AT THE TOP OF BANK ALONG WITH THE COORDINATES OF EACH POINT OR DIMENSIONS TO EACH POINT. WHERE PONDS ARE GREATER THAN 50 FEET, DATA IS TO BE SHOWN IN BOTH PLAN AND SECTION VIEWS.
7. FLOW LINE ELEVATION ON ALL DITCH BREAKS (VERTICAL AND HORIZONTAL).
8. WHERE THE STORM/WATER SEPARATION IS CALLED OUT ON THE PLANS (BE IT PLAN OR PROFILE) OR ANY TIME THE PROPOSED SEPARATION IS LESS THAN 18 INCHES, THE SEPARATION SHALL BE DETERMINED BY THE REGISTERED SURVEYOR. THESE ELEVATIONS SHALL BE TAKEN AT THE CROSSING OR BY CALCULATING FROM THE NEAREST STORM STRUCTURES.

PAVEMENT:

- 1. ROADWAY CENTERLINE PROFILE 100-FOOT MAXIMUM INTERVAL.
2. ROADWAY CROSS SECTIONS 100-FOOT MAXIMUM INTERVAL.

THE FOLLOWING INFORMATION SHALL BE PROVIDED BY THE CONTRACTOR OR BY A LAND SURVEYOR NOT NECESSARILY LICENSED IN THE STATE OF FLORIDA:

WATER:

- 1. TYPICAL MEASUREMENTS BETWEEN EDGE OF PAVEMENT OR OTHER ABOVE-GROUND, PERMANENT FEATURES ARE TO BE PROVIDED FOR ALL WATER MAINS.
2. LOCATION OF WATER SERVICE VALVES AS MEASURED FROM TWO POINTS (I.E., EDGE OF PAVEMENT AND BUILDING CORNER--OR PROPERTY LINE FOR RESIDENCES).
3. TWO DISTANCES FROM PERMANENT, ABOVE-GROUND FEATURES TO MAINLINE VALVES, BACKFLOW PREVENTERS, FITTINGS/ELBOWS AND AIR RELEASE VALVES SHOWING.
4. MEASURED DISTANCES FROM FITTINGS TO THE FIRST UNRESTRAINED PIPE JOINT WHENEVER RESTRAINTS ARE CALLED OUT ON THE PLANS.
5. THE DEPTH FROM THE TOP OF THE VALVE BOX COVER TO THE ACTIVATION NUT (SHOULD BE NOT MORE THAN 6 FEET).

WASTEWATER:

- 1. TYPICAL MEASUREMENTS BETWEEN EDGE OF PAVEMENT OR OTHER ABOVE-GROUND, PERMANENT FEATURES ARE TO BE PROVIDED (FORCEMANS ONLY).
2. MEASURED DISTANCES FROM FITTINGS TO THE FIRST UNRESTRAINED PIPE JOINT WHENEVER RESTRAINTS ARE CALLED OUT ON THE PLANS (FORCEMANS GREATER THAN 2 INCHES IN DIAMETER ONLY).
3. LOCATION OF SEWER CLEAN-OUTS AS MEASURED FROM TWO POINTS (I.E., EDGE OF PAVEMENT AND BUILDING CORNER--OR PROPERTY LINE FOR RESIDENCES).
4. THE DISTANCE BETWEEN FLOAT ELEVATIONS AND THE STATION TOP (MEASURED AT TOP OF THE FLOAT).
5. FOR CITY STATIONS, THE GEOMETRY OF ALL ABOVE-GROUND FEATURES WITHIN THE CITY-CONTROLLED AREA.
6. TWO DISTANCES FROM PERMANENT, ABOVE-GROUND FEATURES TO ALL MAINLINE VALVES, AIR RELEASE VALVES, ELBOWS/FITTINGS, AND CHECK VALVES.

GENERAL NOTES

- 1. ALL MATERIALS AND WORKMANSHIP SHALL CONFORM TO THE FLORIDA DEPARTMENT OF TRANSPORTATION SPECIFICATIONS (LATEST EDITION) AND CITY OF AUBURNDALE REGULATIONS.
2. LOCATIONS, ELEVATIONS, AND DIMENSIONS OF EXISTING UTILITIES, STRUCTURES, AND OTHER FEATURES ARE SHOWN ACCORDING TO THE BEST INFORMATION AVAILABLE AT THE TIME OF PREPARATION OF THESE PLANS. THE CONTRACTOR SHALL VERIFY THE LOCATIONS, ELEVATIONS, AND DIMENSIONS OF ALL EXISTING UTILITIES, STRUCTURES, AND OTHER FEATURES AFFECTING THIS WORK PRIOR TO CONSTRUCTION.
3. THE CONTRACTOR SHALL USE EXTREME CAUTION IN AREAS OF BURIED UTILITIES AND SHALL PROVIDE AT LEAST 48 HOURS NOTICE TO THE UTILITY COMPANIES PRIOR TO CONSTRUCTION TO OBTAIN FIELD LOCATIONS OF EXISTING UNDERGROUND UTILITIES. THE CONTRACTOR SHALL PROTECT AND MAINTAIN OPERATION OF EXISTING UTILITY SERVICES DURING CONSTRUCTION.
4. THE CONTRACTOR SHALL CHECK PLANS FOR CONFLICTS AND DISCREPANCIES PRIOR TO CONSTRUCTION. THE CONTRACTOR SHALL NOTIFY THE ENGINEER OF ANY CONFLICTS BEFORE PERFORMING ANY WORK IN THE AFFECTED AREA.
5. THE ENGINEER (CHASTAIN-SKILLMAN, INC.) SHALL BE NOTIFIED AS TO WHERE EXISTING UTILITY SERVICES INTERFERE WITH THE PROPOSED CONSTRUCTION.
6. THE CONTRACTOR IS RESPONSIBLE FOR REPAIRING ANY DAMAGE TO EXISTING FACILITIES, ABOVE OR BELOW GROUND, THAT MAY OCCUR AS A RESULT OF THE WORK PERFORMED BY THE CONTRACTOR.
7. ALL UNDERGROUND UTILITIES MUST BE IN PLACE AND TESTED OR INSPECTED PRIOR TO BASE AND SURFACE CONSTRUCTION.
8. UTILITIES INSTALLATION SHALL CONFORM TO THE REQUIREMENTS OF THE APPLICABLE STATE AND LOCAL REGULATIONS INCLUDING BUT NOT LIMITED TO THE FLORIDA DEPARTMENT OF ENVIRONMENTAL PROTECTION, THE POLK COUNTY PUBLIC HEALTH UNIT, AND THE CITY OF AUBURNDALE.
9. WATER LINES MAY BE DEFLECTED AS REQUIRED (MAXIMUM OF 3" PER JOINT).
10. CONTRACTOR SHALL VERIFY MINIMUM SEPARATION BETWEEN WATER AND SANITARY / STORM SEWER SYSTEMS. UPON COMPLETION OF CONSTRUCTION, THE CONTRACTOR SHALL PROVIDE WRITTEN VERIFICATION DOCUMENTING THE MINIMUM SEPARATION AS CONSTRUCTED.
11. TYPICAL COVER OVER UTILITY LINES TO BE 36".
12. IT IS THE CONTRACTOR'S RESPONSIBILITY TO BECOME FAMILIAR WITH THE PERMIT AND INSPECTION REQUIREMENTS SPECIFIED BY THE VARIOUS GOVERNMENTAL AGENCIES AND THE ENGINEER. THE CONTRACTOR SHALL OBTAIN ALL NECESSARY PERMITS PRIOR TO CONSTRUCTION, AND SCHEDULE INSPECTIONS ACCORDING TO AGENCY INSTRUCTIONS. ALL WORK PERFORMED SHALL COMPLY WITH THE REGULATIONS AND ORDINANCES OF THE VARIOUS GOVERNMENTAL AGENCIES HAVING JURISDICTION OVER THE WORK.
13. THE CONTRACTOR SHALL SUBMIT SHOP DRAWINGS ON ALL PRE-CAST AND MANUFACTURED ITEMS TO THE ENGINEER FOR APPROVAL. FAILURE TO OBTAIN APPROVAL BEFORE INSTALLATION MAY RESULT IN REMOVAL AND REPLACEMENT AT THE CONTRACTOR'S EXPENSE.
14. AT LEAST THREE (3) WORKING DAYS PRIOR TO CONSTRUCTION, THE CONTRACTOR SHALL NOTIFY THE ENGINEER AND APPROPRIATE AGENCIES AND SUPPLY THEM WITH THE CONTRACTOR'S NAME, STARTING DATE, PROTECTED CONSTRUCTION SCHEDULE, ALL REQUIRED SHOP DRAWINGS, AND OTHER INFORMATION AS REQUIRED. ANY WORK PERFORMED PRIOR TO PROPER NOTIFICATIONS MAY BE SUBJECT TO REMOVAL AND REPLACEMENT AT THE CONTRACTOR'S EXPENSE.
15. ALL DISTURBED AREAS NOT INCLUDED IN THE LANDSCAPE PLANS SHALL BE SODDED. MINIMUM SODDING REQUIREMENTS INCLUDE A 10' PERIMETER STRIP AROUND ALL STRUCTURES, A 2' STRIP ALONG ALL PAVED AREAS, ALL SWALES, AND THE RETENTION AREA SIDESLOPES AND BERMS.
16. COORDINATE WORK WITHIN THE RIGHTS-OF-WAY WITH CITY OF LAKE WALES AND/OR FDOT CONSTRUCTION AND MAINTENANCE AUTHORITIES.
17. THE SITE SHALL BE INITIALLY GRADED SUCH THAT NO OFF-SITE AREA WILL BE ADVERSELY AFFECTED BY STORM WATER RUNOFF. RUNOFF TO THE ADJACENT RIGHTS-OF-WAY SHALL BE MINIMIZED. THE EXISTING DRAINAGE FACILITIES WITHIN THE RIGHTS-OF-WAY SHALL BE PROTECTED AT ALL TIMES BY THE USE OF SYNTHETIC BALES, TEMPORARY GRADING, REVEGETATION, ETC. ANY DISTURBED AREA WITHIN THE RIGHT-OF-WAY SHALL BE SODDED. ALL AREAS SHALL BE PROTECTED FROM EROSION CAUSED BY STORM WATER RUNOFF BY VEGETATION, SYNTHETIC BALES, TEMPORARY GRADING, ETC.
18. UPON COMPLETION OF CONSTRUCTION ACTIVITIES, THE STORM WATER SYSTEMS SHALL BE CLEANED OF ALL SILTS, DEBRIS, LIMESTONE, ETC.
19. THE CONTRACTOR IS RESPONSIBLE FOR PROVIDING CERTIFIED AS-BUILT DRAWINGS UPON COMPLETION OF CONSTRUCTION. THESE AS-BUILT DRAWINGS SHALL INCLUDE DETAILED LOCATIONS OF THE UTILITY SYSTEMS (WATER, SANITARY SEWER, STORM WATER MANAGEMENT SYSTEMS, ELECTRICAL SYSTEMS, ETC.).
20. SAFETY:
A. DURING CONSTRUCTION AND/OR MAINTENANCE OF THIS PROJECT, ALL SAFETY REGULATIONS ARE TO BE ENFORCED. THE CONTRACTOR OR HIS REPRESENTATIVE SHALL BE RESPONSIBLE FOR THE CONTROL AND SAFETY OF THE TRAVELING PUBLIC AND THE SAFETY OF HIS PERSONNEL.
B. LABOR SAFETY REGULATIONS SHALL CONFORM TO THE PROVISIONS SET FORTH BY OSHA IN THE FEDERAL REGISTRY OF THE DEPARTMENT OF TRANSPORTATION.
C. ALL TRENCH EXCAVATION THAT EXCEEDS AN AVERAGE DEPTH OF FIVE (5) FEET MUST CONFORM TO THE REQUIREMENTS STATED IN THE NEW "TRENCH SAFETY ACT" INCORPORATED INTO OSHA STANDARDS (CHAPTER 90 - 96, CS/SR 2628). THE NEW LAW REQUIRES THE CONTRACTOR TO RECOGNIZE THE OSHA EXCAVATION SAFETY STANDARDS, AGREE TO ABIDE BY THEM, AND IDENTIFY THE COST TO COMPLY.
D. THE MINIMUM STANDARDS AS SET FORTH IN THE CURRENT EDITION OF THE STATE OF FLORIDA ROADWAY AND TRAFFIC DESIGN STANDARDS SHALL BE FOLLOWED IN THE DESIGN APPLICATION, INSTALLATION, MAINTENANCE, AND REMOVAL OF ALL TRAFFIC CONTROL DEVICES, WARNING DEVICES, AND BARRIERS NECESSARY TO PROTECT THE PUBLIC AND WORKMEN FROM HAZARDS WITHIN THE PROJECT.
E. ALL TRAFFIC CONTROL MARKINGS AND DEVICES SHALL CONFORM TO THE PROVISION SET FORTH IN THE "MANUAL ON UNIFORM TRAFFIC CONTROL DEVICES" PREPARED BY THE U.S. DEPARTMENT OF TRANSPORTATION, FEDERAL HIGHWAY ADMINISTRATION.

STORMWATER MANAGEMENT SYSTEM OPERATING AND MAINTENANCE PROCEDURES :

THE STORMWATER FACILITIES MUST BE MAINTAINED PROPERLY IF THEY ARE TO PERFORM THE SERVICE FOR WHICH THEY WERE DESIGNED. THIS IS INTENDED TO BE A GUIDE TO THE PROPER WAYS TO MAINTAIN THESE FACILITIES. THIS IS ONLY A GUIDE AND SHOULD BE MODIFIED AS FIELD CONDITIONS REQUIRE.

- 1. MONTHLY, VISUALLY INSPECT INLET OPENINGS TO INSURE THAT NO CLOGGING HAS OCCURRED.
2. ONCE EVERY THREE MONTHS, VISUALLY INSPECT ALL PIPES FOR OBSTRUCTIONS OR A BUILD-UP OF EXCESSIVE SEDIMENTS. IF EXCESSIVE SEDIMENTATION HAS OCCURRED, HAVE ALL LINES PROPERLY FLUSHED.
3. WEEKLY DURING SUMMER MONTHS AND BI-WEEKLY DURING THE REMAINDER OF THE YEAR, MOW ANY GRASS WITHIN THE STORM WATER RETENTION AND COLLECTION AREAS. GRASS CLIPPING SHALL BE COLLECTED AND REMOVED FROM THE SITE FOR PROPER DISPOSAL.

STORM SEWERS --- REINFORCED CONCRETE PIPE

- A. ROUND CONCRETE PIPE: SHALL CONFORM TO REQUIREMENTS OF ASTM C76-70 (CLASS III) EXCEPT AS MODIFIED IN SFSR & BC, SECTION 941-1.3.
B. ELLIPTICAL CONCRETE PIPE: SHALL CONFORM TO REQUIREMENTS OF ASTM C-507 EXCEPT AS MODIFIED IN SFSR & BC SECTION 941.1.3. STANDARD ELLIPTICAL PIPE SHALL MEET THE REQUIREMENTS OF TABLE I FOR CLASS HE-III AND SPECIAL ELLIPTICAL PIPE SHALL MEET THE REQUIREMENTS OF TABLE I FOR CLASS HE-IV.
C. GASKETS: RUBBER GASKETS SHALL BE USED FOR ROUND PIPE AND SHALL MEET THE REQUIREMENTS OF ARTICLE 5.9 ASTM C-361 WITH THE ADDITIONAL REQUIREMENT THAT IT SHALL BE OF SUFFICIENT VOLUME TO FILL THE PIPE JOINT SPACE IN WHICH IT IS USED. ELLIPTICAL PIPE SHALL USE GASKETS IN ACCORDANCE WITH SFSR & BC SECTION 942.2.

Table with columns: NUMBER, DATE, DESCRIPTION, ISSUED FOR REVIEW

CHASTAIN-SKILLMAN
205 EAST ORANGE STREET
SUITE #110
LAKELAND, FL 33801-4611
(863) 646-1402



CITY OF AUBURNDALE
CENTER STREETS/SCALE
CENTER STREET, AUBURNDALE, FLORIDA
GENERAL CONSTRUCTION DETAILS & NOTES

This item has been digitally signed and sealed by Charles D. Forni on the date adjacent to seal. Printed copies of this document are not considered signed and sealed and the signature must be verified on any electronic copies.
March 25, 2024 ENGINEER: CHARLES D. FORNI, P.E. REG. NO.: 86698

PROJECT NUMBER: 1037001
SHEET NUMBER: C-04

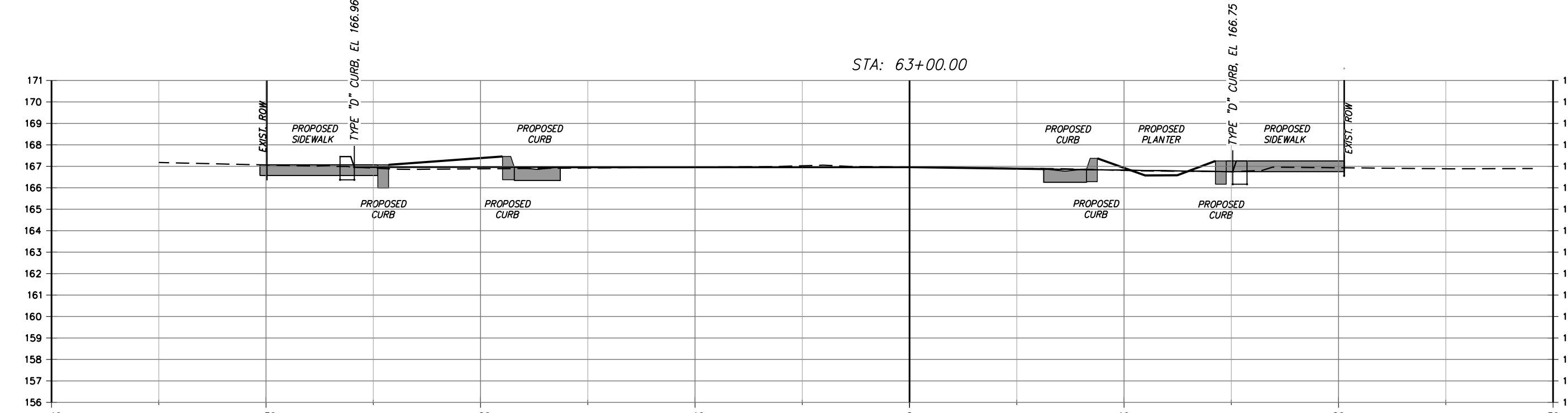
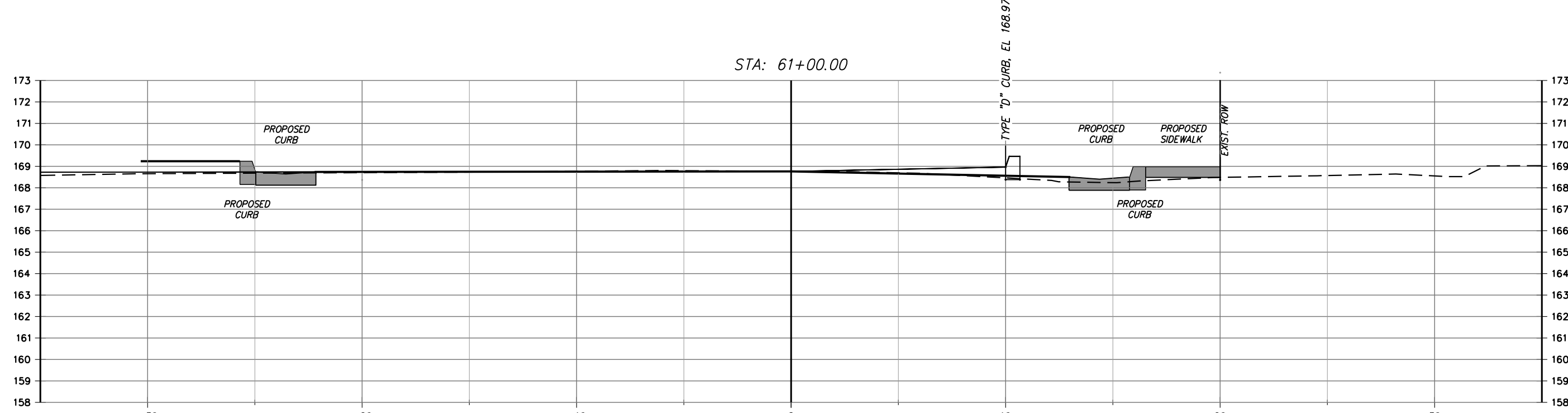
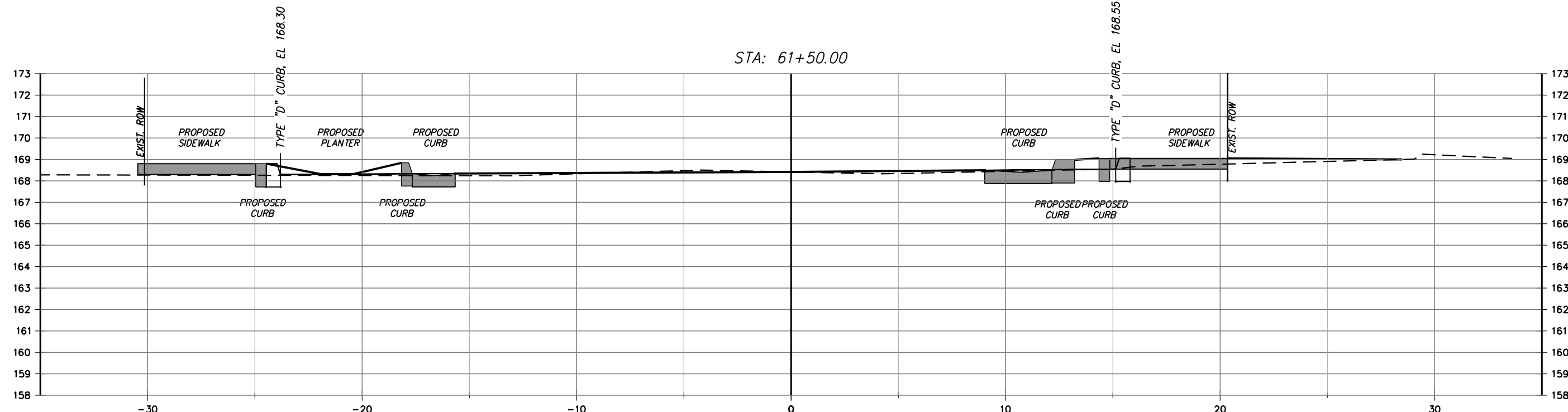
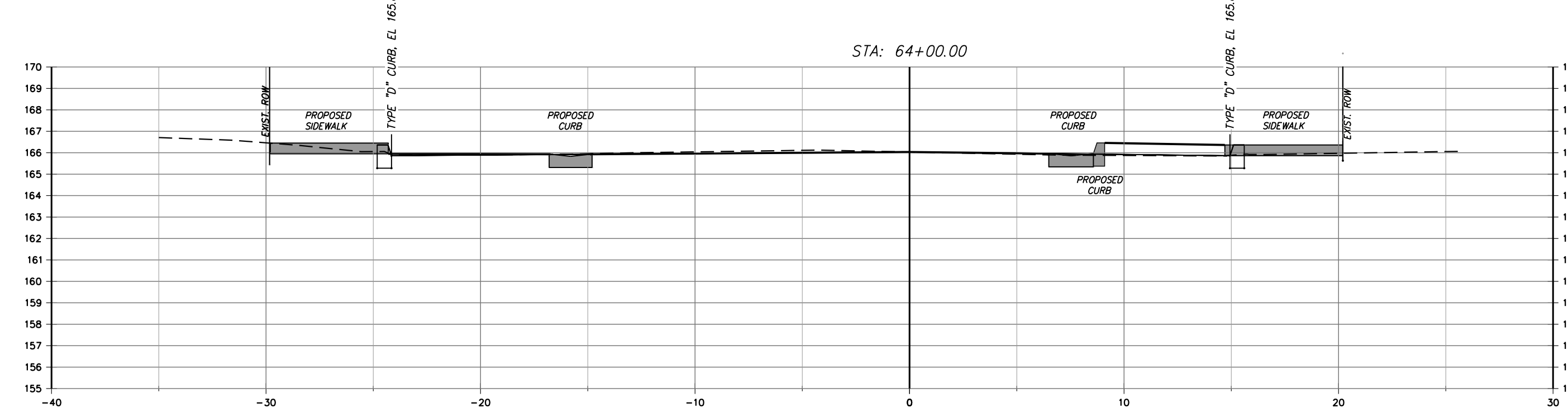
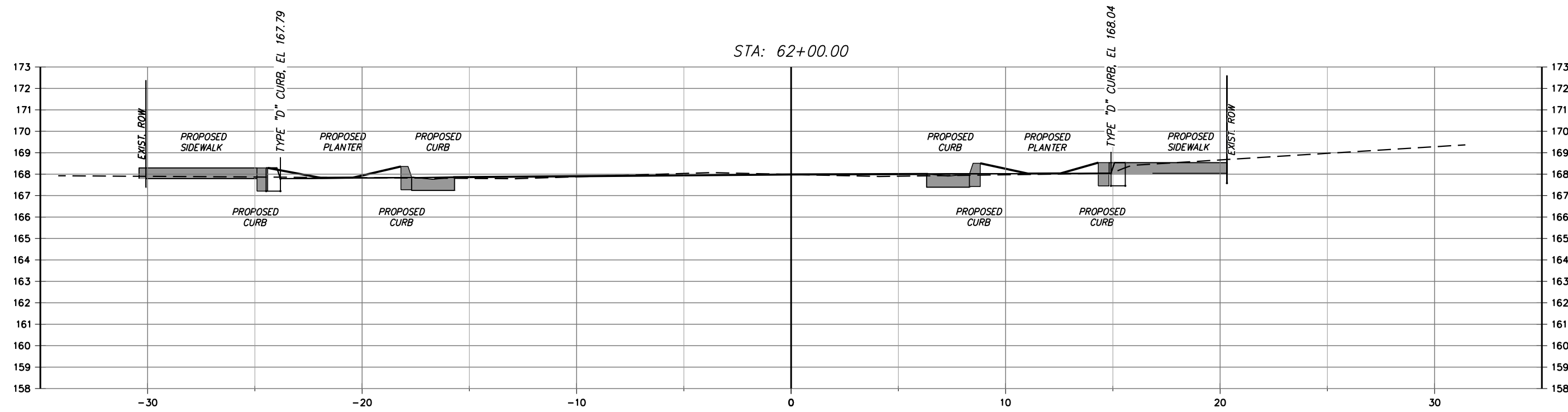
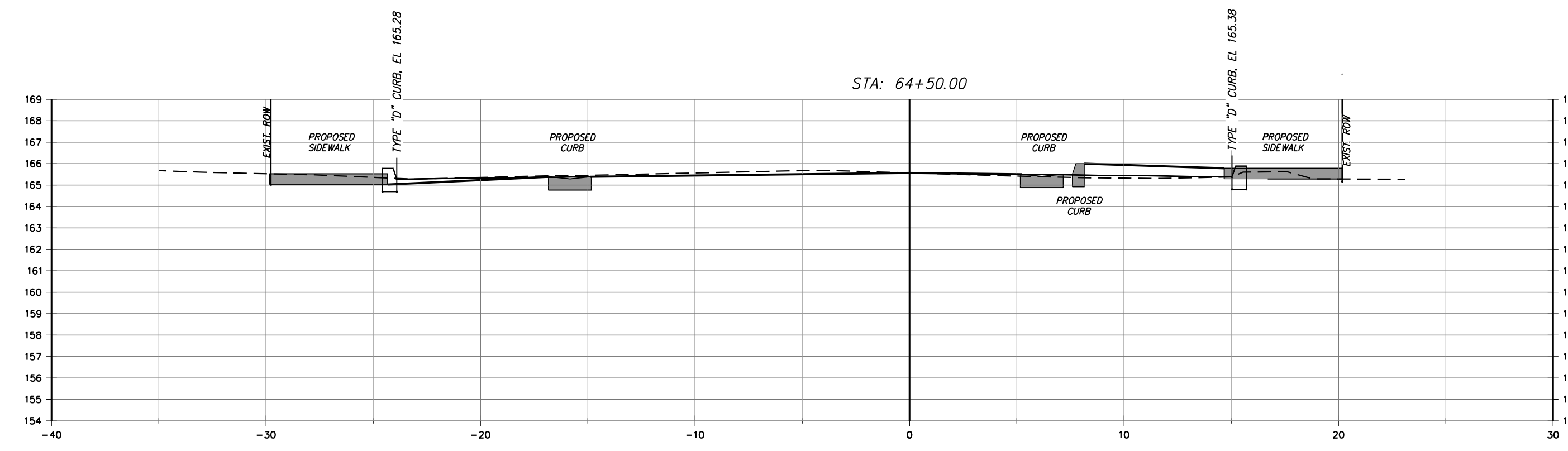
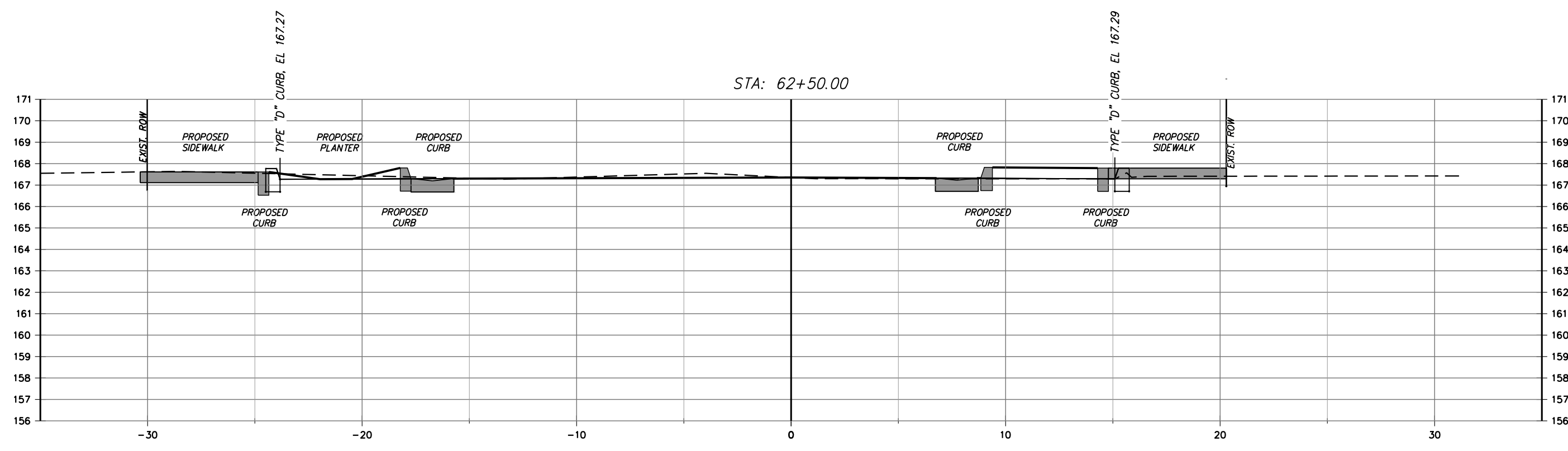

1" = 5' Horizontal
1" = 5' Vertical

P:\1037001\CAD\Civil\1037001\Production Drawings\1037001-CDF-2023-XS.dwg XS-07 Mar 25, 2024 11:18am by: erodriguez

NUMBER	DATE	DESCRIPTION
P-0	3/23/2023	ISSUED FOR REVIEW

CHASTAIN-SKILLMAN
205 EAST ORANGE STREET
SUITE #110
LAKELAND, FL 33801-4611
(863) 646-1402

© 2023 CHASTAIN SKILLMAN REG. NO. 282



CITY OF AUBURNDALE
CENTER STREETSCAPE
CENTER STREET, AUBURNDALE, FLORIDA

ROADWAY CROSS SECTIONS

This item has been digitally signed and sealed by Charles D. Forni on the date adjacent to seal. Printed copies of this document are not considered signed and sealed and the signature must be verified on any electronic copies.

March 25, 2024 ENGINEER: CHARLES D. FORNI, P.E.
REG. NO.: 86698

PROJECT NUMBER:
1037001

SHEET NUMBER:
C-05

P:\1037001\CAD\Civil\1037001\Production Drawings\1037001-CDF-2023-XS.dwg XS-08 Mar 25, 2024 11:18am by: erodriguez

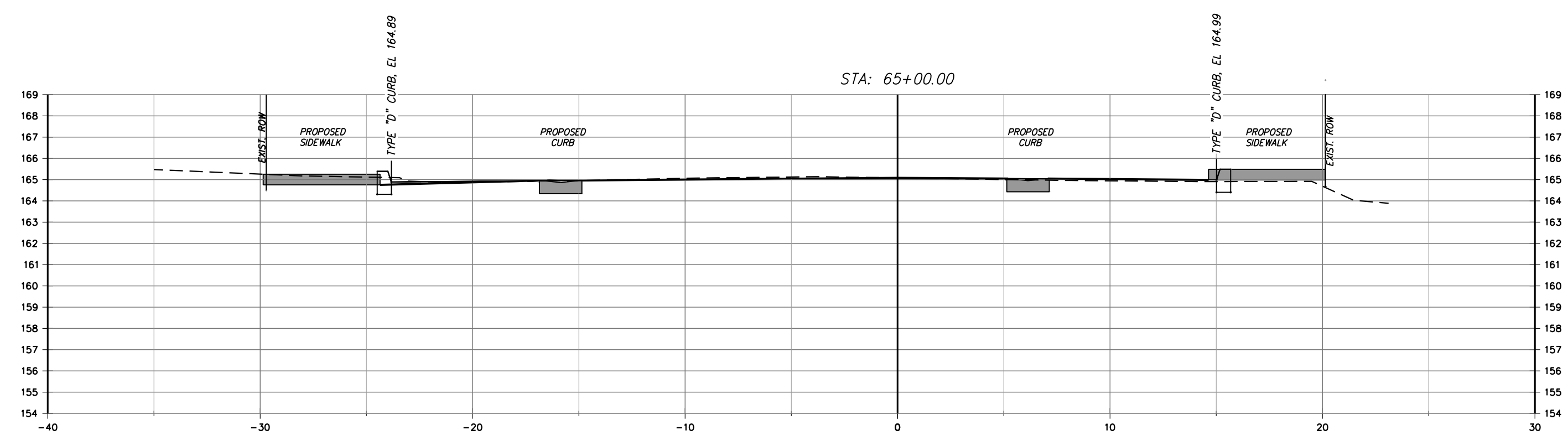
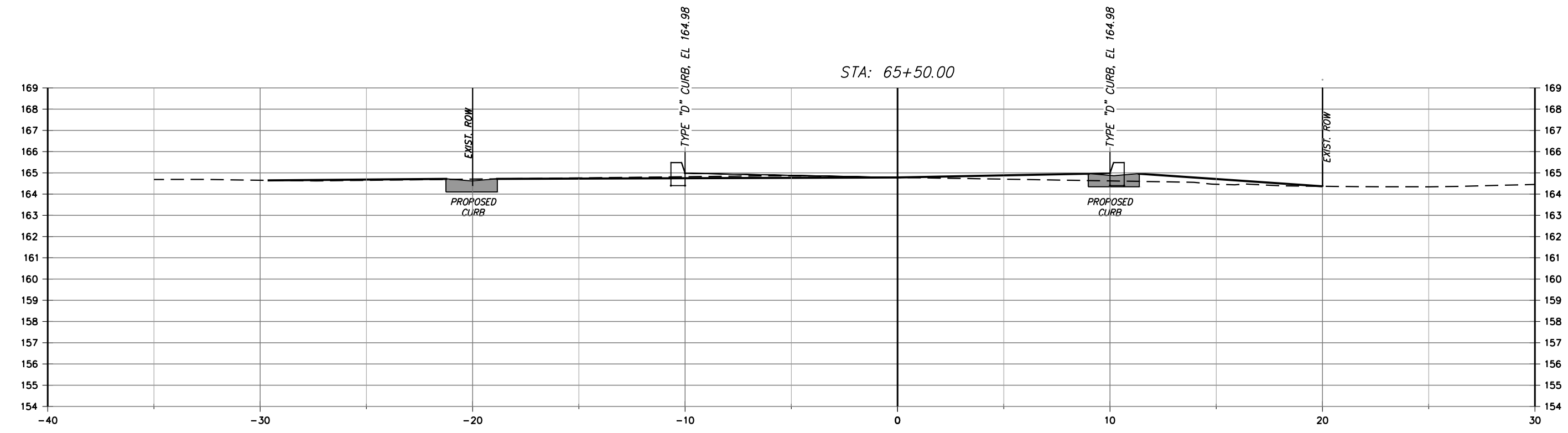

1" = 5' Horizontal
1" = 5' Vertical

NUMBER	DATE	DESCRIPTION
P-0	3/2023	ISSUED FOR REVIEW

CHASTAIN-SKILLMAN
205 EAST ORANGE STREET
SUITE #110
LAKELAND, FL 33801-4611
(863) 646-1402

© 2023 CHASTAIN SKILLMAN REG. NO. 282



CITY OF AUBURNDALE
CENTER STREETScape
CENTER STREET, AUBURNDALE, FLORIDA

ROADWAY CROSS SECTIONS



This item has been digitally signed and sealed by Charles D. Forni on the date adjacent to seal. Printed copies of this document are not considered signed and sealed and the signature must be verified on any electronic copies.

March 25, 2024 ENGINEER: CHARLES D. FORNI, P.E.
REG. NO.: 86698

PROJECT NUMBER:
1037001

SHEET NUMBER:
C-06

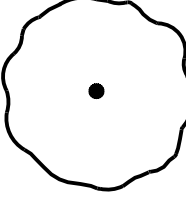
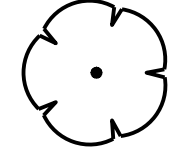
CONCEPT PLANT SCHEDULE

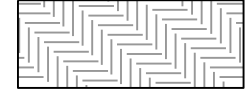
	CANOPY TREES	15
	UNDERSTORY TREES	2
	PALMS	11
	SHRUBS & GROUNDCOVER	3,035 SF

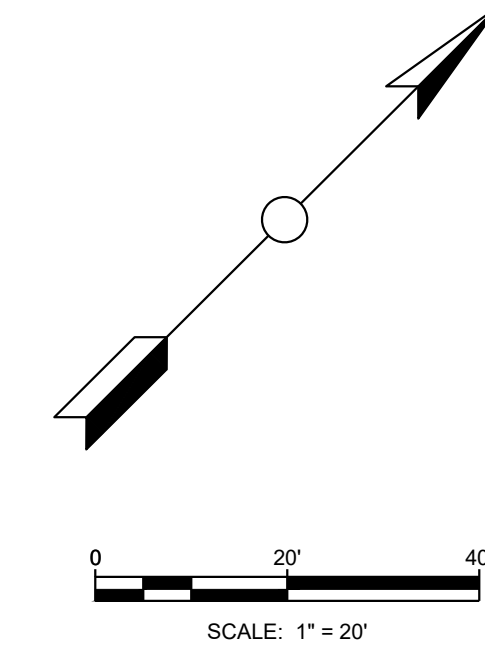

STA. 61+10 SEE 'PALMETTO STREETSCAPE' PLANS FOR CONTINUATION

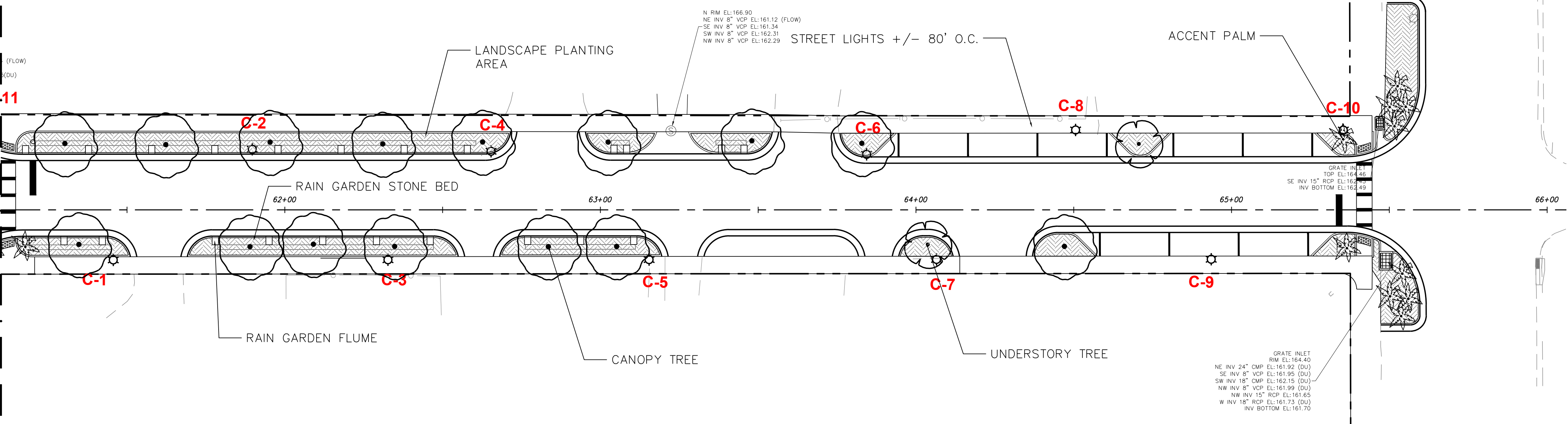

(FLOW)
(DU)

.11

P-13

-15

NUMBER	DATE	DESCRIPTION
P-0	1/2023	ISSUED FOR REVIEW

CHASTAIN-SKILLMAN
205 EAST ORANGE STREET
SUITE #110
LAKELAND, FL 33801-4611
(863) 646-1402



© 2023 CHASTAIN SKILLMAN REG. NO. 282

CITY OF AUDURDALE
CENTER STREETSCAPE
CENTER STREET, AUBURNDALE, FLORIDA

LANDSCAPE PLAN

This item has been digitally signed and sealed by Charles D. Forni on the date adjacent to seal. Printed copies of this document are not considered signed and sealed and the signature must be verified on any electronic copies.

March 25, 2024 ENGINEER: CHARLES D. FORNI, P.E.
REG. NO.: 86698

PROJECT NUMBER:
1037001

SHEET NUMBER:
L-01

P:\1037001\CAO\Gis\1037001\Production\Drawings\1037001-CDF-2023-LANDSCAPE.dwg CENTER Mar 25, 2024 11:19am By: eric@skm